

NOTICE!!

These documents have been scanned!

Do not place un-scanned documents beneath this notice!

Do not remove this notice from this file!

GPO Jacket No. 560-102
Print Order 61540
Rise Business Services, LLC
Job=AZ15 5/22/2019



Box Number= AZ15076



Claim Begin-End: AMC396287-AMC396292

1 Initial Receipt



AZ15076-10

AMC396025-AMC396393

United States Department of the Interior
Bureau of Land Management
 BUSINESS & SUPPORT SVCS DIV
 ONE N CENTRAL AVE SUITE 800
 PHOENIX, AZ 85004 -4427
 Phone: (602) 417-9200

Receipt

No:

1886563

Transaction #: 1948325

Date of Transaction: 03/12/2009

ENTERED INTO COMPUTER

CUSTOMER: TIMOTHY M MARSH
 9420 E PLACITA OAXACA
 TUCSON, AZ 85749-9272 US

4/9/09 By D. Jones

LINE #	QTY	DESCRIPTION	REMARKS	UNIT PRICE	TOTAL
1	6.00	LOCATABLE MINERALS / MINING CLAIMS- NEW, UNADJUD, ONE OR MORE AUTH NOS / NEW MINING CLAIM PROCESSING FEE \$15 CASES: AMC396287/\$15.00, AMC396288/\$15.00, AMC396289/\$15.00, AMC396290/\$15.00, AMC396291/ \$15.00, AMC396292/\$15.00		- n/a -	90.00
2	6.00	LOCATABLE MINERALS / MINING CLAIMS- NEW, UNADJUD, ONE OR MORE AUTH NOS / NEW MINING CLAIM LOCATION FEE \$30 CASES: AMC396287/\$30.00, AMC396288/\$30.00, AMC396289/\$30.00, AMC396290/\$30.00, AMC396291/ \$30.00, AMC396292/\$30.00		- n/a -	180.00
3	6.00	LOCATABLE MINERALS / MINING CLAIMS- NEW, UNADJUD, ONE OR MORE AUTH NOS / NEW MINING CLM MAINT FEE \$125 (1993 CASES: AMC396287/\$125.00, AMC396288/\$125.00, AMC396289/\$125.00, AMC396290/\$125.00, AMC396291/ \$125.00, AMC396292/\$125.00		- n/a -	750.00
TOTAL:					\$1,020.00

PAYMENT INFORMATION

1	AMOUNT:	1020.00	POSTMARKED:	N/A
	TYPE:	CHECK	RECEIVED:	03/12/2009
	CHECK NO:	1004		
	NAME:	BELL RESOURCES (NEVEDA) CORPORATION 9420 E PLACITA OAXACA TUCSON AZ 85749-9272 US		

official electronic record contained therein.

NOTICE!!

These documents have been scanned!

Do not place un-scanned documents beneath this notice!

Do not remove this notice from this file!

GPO Jacket No. 560-102
Print Order 61540
Rise Business Services, LLC
Job=AZ15 5/22/2019



Box Number= AZ15076



Claim Begin-End: AMC396287-AMC396292

2 Correspondence



AZ15076-10

AMC396025-AMC396393

**NO
DOCUMENTS
FOUND**

NO DOCUMENTS FOUND
NO DOCUMENTS FOUND

NOTICE!!

These documents have been scanned!

Do not place un-scanned documents beneath this notice!

Do not remove this notice from this file!

GPO Jacket No. 560-102
Print Order 61540
Rise Business Services, LLC
Job=AZ15 5/22/2019



Box Number= AZ15076



Claim Begin-End: AMC396287-AMC396292

3 Transfers



AZ15076-10

AMC396025-AMC396393

Snell & Wilmer

L.L.P.
LAW OFFICES

One South Church Avenue
Suite 1500
Tucson, Arizona 85701-1630
520.882.1200
520.884.1294 (Fax)
www.swlaw.com

Rebecca F. Cary, Paralegal
(520) 882-1387
rcary@swlaw.com

AMC 357560
357853
357871
357873
358032

AMC 358745
358746
359987
360058

10 371533
396287
405285

DENVER
LAS VEGAS
LOS ANGELES
LOS CABOS
ORANGE COUNTY
PHOENIX
RENO
SALT LAKE CITY
TUCSON

October 18, 2013

FEDERAL EXPRESS

United States Department of the Interior
Bureau of Land Management
Adjudicator's Office
Attn: Amy Thrower
Arizona State Office
One North Central Avenue
Suite 800
Phoenix, Arizona 84005-4427

RECEIVED
BLM AZ STATE OFFICE
2013 OCT 22 A 9:13
PHOENIX, ARIZONA

RE: Copper Fox Sombrero Butte Co. and Copper Fox Van Dyke Co. – Name Change

Dear Amy:

Pursuant to our recent telephone conversation, enclosed is this Firm's check in the amount of \$900.00 to cover the transfer fees for the unpatented mining claims associated with the above-referenced entities.

Enclosed are copies of our letters dated September 18, 2013 with respect to the name change for each corporation.

Please contact me at (520) 882-1387 if you have any questions or need anything further to complete the transfer.

Very truly yours,

Rebecca F. Cary
Paralegal

RFC/al
Enclosures
cc: Jim Allen, Esq.

ENTERED
NOV 22 2013
BY:

Snell & Wilmer

LLP
LAW OFFICES

One South Church Avenue
Suite 1500
Tucson, Arizona 85701-1630
520.882.1200
520.884.1294 (Fax)
www.swlaw.com

James P. Allen, Esq.
(801) 257-1956
jpallen@swlaw.com

DENVER
LAS VEGAS
LOS ANGELES
LOS CABOS
ORANGE COUNTY
PHOENIX
RENO
SALT LAKE CITY
TUCSON

September 18, 2013

United States Department of the Interior
Bureau of Land Management
Attn: Adjudicator
Arizona State Office
One North Central Avenue
Suite 800
Phoenix, Arizona 84005-4427

RE: Copper Fox Van Dyke Co.

Dear Sir or Madam:

This Firm represents Copper Fox Van Dyke Co. (the "Corporation"), which is the owner of 35 unpatented mining claims located in Gila County, Arizona, as set forth on the attached Exhibit A.

This letter is to notify the Department that the Corporation has changed its name to Desert Fox Van Dyke Co. A copy of the approved name change from the Arizona Corporation Commission is attached as Exhibit B.

Please contact me at (801) 257-1959 if you have any questions or need anything further to complete the transfer.

Very truly yours,



James P. Allen

JPA:jmc
Enclosures

RECEIVED
BLM AZ STATE OFFICE
2013 OCT 22 A 9:11
PHOENIX, ARIZONA

EXHIBIT A

Any and all interest in and to the following real property, specifically limited to the mineral rights and interests in and underlying said real property located in Township 1 North, Ranges 14 and 15 East, Gila and Salt River Meridian, Gila County, Arizona, granted to Bennu Properties, LLC by that certain Judgment dated September 14, 2011, and that certain Partial Judgment dated November 23, 2011, as represented by the following Gila County Assessor Tax Parcel Numbers:

RECEIVED
BLM AZ STATE OFFICE
2013 OCT 22 A 9:14
ARIZONA

Gila County Assessor Parcel Number	Legal Description
04 204-13-005-E-1	Legal Description: PAT MNG CLAIMS SEC 36 1N 14E PT ONWARD & ONWARD #2 MS3243 16. 3AC (SEE DKT 580 PAGE 77 FOR SUB-SURFACE RIGHTS)
04-204-13-005-F-0 (NOTE: Assessor lists this as 04 204-13-005-G and 04 204-13-005-H)	patent mining claims sec 36 in 14e solace #2 ms 2403 & onward #3 ms 32 43 exc n 158' of e 200' of solace #2 33. 7AC (see dkt 580 page 77 for sub-surface rights (Assessor lists 04 204-13-005-G as Legal Description: PAT MINING CLAIM ONWARD #3, MS 3243 SEC 36 T1N R14E = 20.67 AC (OUT OF 204-13-005F) FOR SUB-SURFACE RIGHTS) and 04 204-13-005-H as Legal Description: PAT MINING CLAIMS SOLACE #2, MS 2403 , LESS & EXCEPT THE NORTH 158' OF THE EAST 200' SEC 36 T1N R14E = 12.46 (OUT OF 204-13-005F)
04-204-13-016- -8	Legal Description: PAT MNG CLAIMS SEC 36 1N 14E MS3254 BLUE BELL #3 EXC PTSOLD 23. 5AC (SEE DKT 580 PAGE 77 FOR SUB-SURFACE RIGHTS)
04-204-13-017-A-0	Legal Description: PAT MNG CLAIM SEC 36 1N 14E E PT BLUE BELL #2 MS 3254 5AC (SEE DKT 580 PAGE 77 FOR SUB-SURFACE RIGHTS)
04 204-13-017-B-9	Legal Description: PAT MNG CLAIM SEC 36 1N 14E W PT BLUE BELL #2 MS 3254 EXCPT SOLD 5AC (SEE DKT 580 PAGE 77 FOR SUB SURFACE RIGHTS)
04 204-13-019- -7	Legal Description: PAT MNG CLAIM SEC 36 1N 14E SOLACE #1 MS2403 EXC BEG COR #1 TH N 25DEG 17MIN W 583.8' TH S 78DEG 18MIN W 400' TH S26DEG 45MIN W 40 0' TH S 52DEG 05MIN E 334.9' TH N 78DEG 13MIN E 568.9' TO POB 11 .29AC

04 204-13-515- -0

Legal Description: PT SECS 35 & 36 T1N R15E SUB SUR RTS
BELOW 40' OF REDCLOUD & SNAIL MNG CLAIMS (SEE DKT 580
PAGE 77 FOR SUB-SURFACE RIGHTS)

04 204-13-520- -4

Legal Description: PAT MNG CLAIM SEC 36 IN 15E PT LONG
SHOT MS2403 SUB SURF RTS BELO W 40' ON WLY 600' 8.1AC
(SEE DKT 580 PAGE 77 FOR SUB-SURF RIGHTS)

04 204-14-012-E-4

Legal Description: PAT MINING CLAIMS SULPHIDE & SULPHIDE
#2 SUR 3254 S OF SMELTER CANYON ROAD 4AC (SEE DKT 580
PAGE 77 FOR SUB-SURFACE RIGHTS)

04 204-14-013-A-1

Legal Description: PAT MNG CLAIMS SEC 36 IN 14E SHO ME #2
COPPER CENTER & SULPHIDE#1 MS3232 EXC PT SUB. & ELY PT
OUT OF CITY LIMITS 4.28AC IPR ON (898-50-041A) (SEE DKT 580
PAGE 77 FOR SUB-SURFACE RIGHTS)

04 204-14-013-B-0
(NOTE: Assessor
lists this as 04 204-
14-013D and 04
204-14-013E)

patent mining claims sec 36 in 14e sho me #2 copper center & sulphide
#1 ms 3232 exc pt sub & pt w of city limits 11. 5ac (see dkt 580 page 77
for sub-surface rights; (Assessor shows legal description for 04 204-14-
013D as BEG AT COR NO. 2 OF SHOW ME NO 2 MS 3232; TH S20 39'W, 620.0'; TH S20 39'W, 539.0(C); TH N39 0'54 W, 214.46'(C); TH
N25 12'30 E, 136.15'; TH N29 42'E, 30.61'; TH S60 18'E, 35.0'; TH N29
42'E, 106.1'; TH N60 18'W, 35.0'; TH N29 42'E, 120.0'; TH N60
18'W, 65.0'; TH N29 42'E, 381.02'; TH S23 20'E, 81.35'; TH S86 49'E,
16.76'; TH S75 09'E, 15.51'; TH NORTH 120.68'; TH N10 15'E, 169.92';
TH N89 59'E, 131.97' TO THE POB NESEC 36 T1N R14E; = 3.62 AC
(OUT OF 204-14-013B) and 04 204-14-013E as BEG AT COR 1 OF
SULPHIDE NO 1 MS 3232; TH N85 36'W, 676.53'(C); TH N47 27'E,
45.9'; TH WEST 440.95'(C); TH N29 39'E, 746.7'; TH N50 06'E, 30.0';
TH S39 54'E, 262.37'; TH S33 16'W, 657.48' TO THE POB NESEC 36
T1N R14E; = 4.97 AC(OUT OF 204-14-013B)

RECEIVED
MAY 14 2 09 PM '14
COUNTY CLERK'S OFFICE

- 04 204-14-501-B-0 Legal Description: PT OF SECS 25 26 35 & 36 T1N R15E (UNSURVEYED) THE SUBSURFACE RIGHTS OF GREATER THAN 500'IN DEPTH OF IRON LODGE; ORPHAN; CRACKER JACK; WHITE CAPTIVE; VESPER MINE & CHIEF MNG CLAIMS MS 3069& LYNG SW OFSPRR R/W & FLLWNG DESC LINE BEG AT A PT ON NW LINEOF IRON LODEMNG CLAIM WHBEARS S 81DEG 01MIN W 293.9' FROM NW COROF SAID IRONLODE TH S 83DEG 51MIN 30SEC E 906.8' TH S 71DEG37MIN30SEC E 292.2' TH S 75DEG 39MIN 30SEC E 345.7' TH S68DEG 26MIN30SEC E 232.7' TH N 35DEG 26MIN E 103.6' M/LTO SWLYR/W LINE OF SPRR EXC THOSE PCLS SOLD DESC IN BKTO MINES 19/25 & 39
- 04 204-14-502- -5 Legal Description: SUBSURFACE RIGHTS GREATER THEN 500 FEET SHO ME NO 2; GRAY COPPER; COPPER CENTER & SULPHIDE NO 1 UNDERLYING SUBSURFACE RIGHTS SOLD (SEE DKT 580 PAGE 77 FOR SUB-SURFACE RIGHTS)
- 04 204-15-574- -7 Legal Description: SUBSURFACE RIGHTS BELOW 500' UNDER LOT 1 OR BALANCE EASY MONEY FRAC & PT SHO ME MC SEC 25 T1N R15E DEEDS 37/621 & 623 (SEE DKT 580 PAGE 77 FOR SUBSURFACE RIGHTS)
- 04 204-16-004- -1 sho me #2 mining claim lot 1 blk 63 bk 14 pg 136 of mining deeds (see (NOTE: Assessor's records show this parcel as 04 204-16-014) dkt 580 page 77 for sub-surface rights) (Assessor's records show the legal description of 04 204-16-014 as Legal Description: SHO ME #2 MINING CLAIM LOT 1 BLK 63 BK 14 PG 136 OFMINING D EEDS (SEE DKT 580 PAGE 77 FOR SUB-SURFACE RIGHTS)
- 04 204-16-031- -0 Legal Description: BALANCE OF COPPER CNTR MNG CLAIM MINERAL SUR #3232 IN SEC36 1N 14 E NE NE (SEE DKT 580 PAGE 77 FOR SUB-SURFACE RIGHTS)
- 04 204-16-035- -2 Legal Description: PT NW4 SEC 31 1N 15E PT WITHIN WESTWARD ADD SEC NUMBERED LOTS (SEE DKT 580 PAGE 77 FOR SUB-SURFACE RIGHTS)
- 04 206-16-036- -5 Legal Description: PT COPPER CENTER MC SEC 36 1N 14E COM AT PNT FROM WH SWCOR SEC 30 1N 15E BEARS N 20DEG 27MIN 30SEC E 685.3' TH S20DEG 34MIN E 96 .2' TO POB TH S 20DEG 34MIN E 145.6' TH N74DEG 35MIN W 247.8' TO RR R/W TH N 69DEG 26MIN E 200'(SEE DKT 580 PAGE 77 FOR SUB-SURFACE RIGHTS)

REC'D
A 9 14
OFFICE

04 206-08-005- -6

Legal Description: PAT MINING CLAIM S H VAN SLYCK PAT #91944 BAL OF THE SHO ME SEC 3 0 1N 15E AC FRACT (SEE DKT 580 PAGE 77 FOR SUB-SURFACE RIGHTS)

04 206-23-501- -2

Legal Description: SUBSURF RIGHTS BELOW 500' ON PT MYRTLE PAT MNG CLAIM SW SEC 30 T 1N R15E COM W4 COR SEC 30 TH S 27DEG 59MIN E 790'TH S 69DEG 15MINE 603.81' TO POB TH S 69DEG 15MIN E 464.76' TH S 53DEG 42MINW 17.21' TH S 36DEG 18MIN E 321.16' TH S 62DEG 55MIN W 272.1 ' TH N 162.23' TH W 818.83' TH N 69DEG 15MIN W 62.75' TH N 5 3DEG 42MIN E 631.6' TO POB; ALSO BEG ON LINE 3-4 AT N LINE LOT 4 TH E 818.83' TH S 162.23' TH S 62DEG 55MIN W 187.84' TO COR # 3TH N 69DEG 15MIN W 696.95' TO POB EXC RR R/W SUBSURF RIGHTS BELOW 40' LOT 4 PT SW SW SEC 30 T1N R15E EXC BEGSW COR SEC 30 T H N 260' TH S 36DEG 22MIN 20SEC E 169.28' TO SP R/W TH ALNG R/W T O S BNDRY SEC 30 TH W ALNG S BNDRY TO POB ALSO LOT 8 SEC 30 NW SW

04 206-23-502- -5

Legal Description: SUBSURFACE RIGHTS PART EASY MONEY FRAC IN SEC 25 T1N R14EDEEDS 37 /621 & 623 (SEE DKT 580 PAGE 77 FOR SUB-SURFACE RIGHTS)

04 206-23-504- -1

Legal Description: SUBSURFACE RIGHTS BELOW 500' ON PT SHO ME CLAIM BEG AT PTFROM WHI CH SW COR SEC 30 T1N R15E BEARS S 42DEG 25MIN E 420.02' TH N 36D EG 23MIN W 390' TH N 53DEG 37MIN E 125'TH S 36DEG 23MIN E 390' TH N 53DEG 37MIN E 75' TH S 36DEG 23MIN E 29' TH S 20DEG 39MIN W 1 78.8' TH N 36DEG 23MIN W 100.24' TH S 53DEG 37MIN W 50' TO POB

04 206-23-505- -4

Legal Description: SUBSURFACE RIGHTS BELOW 40' ON SHO ME CLAIM M S 2540 EXC PCLS SOL D(SEE DKT 580 PAGE 77 FOR SUB-SURFACE RIGHTS)

04 206-07-502- -9

Legal Description: SUBSURFACE RIGHTS BELOW 40' OF SW SW & NW SW EXC N2 N2 NWSW SEC 3 3 T1N R15E 67.6AC

04 206-07-503- -2

Legal Description: SUBSURFACE RIGHTS BELOW 40' E2 SE; E2 NW SE & SW SE EXCNW NW SWSE SEC 33 T1N R15E 131.3AC

- 04 206-08-501- -9 Legal Description: PT OF SE OF SEC 30 IN 15E LYNG S OF RR & S
& E OF BUENAVISTA TE RR OF TOWN OF MIAMI (SEE DKT 580
PAGE 77 FOR SUB-SURFACE RIGHTS)
- 04 206-08-503- -5 Legal Description: SEC 30 IN 15E SUBSUR RIGHTS IN PCL LYNG
IN SENW OF SEC 30PCL BEIN G BOUNDED ON S BY MIAMI
CITY LIMITS PCL BEING PT OF PCL DESC 27/2 75 (SEE DKT 580
PAGE 77 FOR SUB-SURFACE RIGHTS)
- 04 206-08-504- -8 Legal Description: SEC 30 IN 15E SUBSUR RIGHTS IN PCL LYNG
IN SW NE OF SEC30 BEINGBOUNDED ON THE S BY MIAMICITY
LIMITS PCL BEINGPT OF PCL DESC I N 27/275
- 04 206-08-505- -1 Legal Description: SEC 30 1N 15E SUBSUR RIGHTS IN PCL LYNG
IN SE NE SEC 30BOUNDED ON S BY MIAMI CITY LIMITS PCL
BEING PT OF PCLDESC IN 27/275
- 04 206-08-506- -4 Legal Description: BEG SE COR NW4 SEC 30 TH S 89DEG 58MIN W
1267.16' TO 'SWCOR SE N W TH N 0DEG 7MIN 7SEC W 799.82' TO
NE COR REDSPRINGS & SE CORS & JOHNS #2 TH S 78DEG
25MIN E 153.44' TH S 78DEG 25MIN E 540.2 6' TH S 1DEG 03MIN
20SEC E 319.28' TH N 57DEG 40MIN E 1364. 77' TH S 35DEG
50MIN E 594.9' TH S 35DEG 50MIN E 5.1' TH N 57DE G 40MIN E
1500'TH S 35DEG 50MIN E 175.13' TH N 57DEG 35MIN E 21 9.45'
TH S 1DEG 02MIN 20SEC W 1354.95' TH S 89DEG 58MIN 38SEC
W2323.3' TH S 89DEG 58MIN 38SEC W 161.67' TO POB LESS PTS N
OF MI AMI TWNS LIMITS 67.4AC 11/372 SUBSURF RIGHTS
ONLY
- 04 206-08-507-A-6 Legal Description: SUBSURFACE RIGHTS POR NWLY/2 OF THE S/2
SW/4 THE SE/4 OF SEC 29 T1N R15E. OUT OF 206-08-507
- 04 206-08-507-B5 Legal Description: POR SELY/2 OF THE S/2 SE/4 & THE SE4 OF SEC
29 T1N R15E SUBSURFACE ONLY OUT OF 206-08-507
- 04 206-13-501- -3 Legal Description: SUBSUR RIGHTS PT OF VAN DYKE PAT
#284767 BEING PT OF NWSE OF SE C 30 IN 15E LYNG SE OF
ARIZ EASTERN RR R/W & LYNGN OF MILTON ADD (NOW
ABANDONED)(SEE DKT 580 PG 77 FOR SUB-SURFACE RIGHTS)

RECEIVED
 CIVIL ENGINE
 4/22 A 9:10

- 04 206-13-502- -6 Legal Description: SUB SURF RIGHTS PT OF VAN DYKE PAT #248767 BEING PT OF THE NW S E OF SEC 30 IN 15E LYNG SE OF AZ EASTERN RR R/W &N OF MOUNTAIN VI EW SUB(SEE DKT 580 PG 77 FOR SUB-SURFACE RIGHTS)
- 04 206-18-141- -6 Legal Description: SUR RIGHTS IN PCL LYNG E OF KENNEY DRIVE OF RED SPRINGSADD TO O RIG TWNS OF MIAMI IN SEC 30SW NW T1N R15E
- 04 206-18-501- -8 Legal Description: SUB SUR RTS BELOW 200' IN TRI IN NW SW SEC 30 DESC 2AC
- 04 206-19-501- -1 Legal Description: SUBSURF RIGHTS BELOW 40' OF PT SEC 30 T1N R15E BEG SW CORSE NW SE C 20 TH N 0DEG 07MIN W 799.82' TO NE COR RED SPRINGS ADD TH N78DEG 25MIN W TO NW COR RED SPRINGS ADD TH S 01DEG 02MIN E 1578.2' TH S 39DEG 22MIN E 260' TH S69DEG 15MIN E 602.55' TO E BNDRYRED SPRINGS ADD TH S69DEG 15MIN E 551.1' TH S 62DEG 55MIN W 163.1' TH N 89DEG52MIN E 1283.5' TO SE COR ORIGINAL TWNS MIAMI THN 0DEG7MIN W 1312.9' TO NE COR ORIGINAL TWNS MIAMI TH S 89DEG44MIN W 1279.7' TO POB MINES 17/86 90.26AC
- 04 206-21-501- -6 Legal Description: SUBSURFACE RIGHTS BELOW 500' LOTS 1, 2, 3 & 4 OF BLOCK 4 HIGH SCHOOL ADDITION PLAT 55
- 04 206-21-502- -9 Legal Description: SUBSURFACE RIGHTS BELOW 500 OF LOTS 1 & 2 BLOCK 5 HIGH SCHOOL ADDITION PLAT 55, SEC 30 TIN R15E
- 04 206-21-503- -2 Legal Description: SUBSURFACE RIGHTS BELOW 500', ALL OF BLK 6 OF HIGH SCHOOL ADDITION PLAT 135
- 04 206-21-504- -5 Legal Description: SUBSURFACE RIGHTS BELOW 500', LOTS 2, 3, 4, 5, 6, 7 & 8 OF BLOCK 8, HIGH SCHOOL ADDITION PLAT 55
- 04 206-21-505- -8 Legal Description: SUBSURFACE RIGHTS BELOW 500' OF LOTS 3, 4, 5, 6, 7 & 8 BLOCK 9 IN HIGH SCHOOL ADDITION PLAT 135
- 04 206-21-506- -1 Legal Description: SUBSURFACE RIGHTS BELOW 500' OF LOTS 1 THRU 19 OF BLOCK 10 IN HIGH SCHOOL ADDITION PLAT 55

FILED
 OCT 22 A 9 11
 2012

04 206-21-507- -4 Legal Description: SUBSURFACE RIGHTS BELOW 500 OF LOTS 4
& 5 OF BLOCK 11 OF 'HIGH SCHOOL ADDITION PLAT 135

04 206-21-508- -7 Legal Description: SUBSURFACE RIGHTS BELOW 500' OF ALL OF
BLOCK 12 OF HIGH SCHOOL ADDITION PLAT 55

04 206-21-509- -0 Legal Description: SUBSURFACE RIGHTS BELOW 500' OF LOTS 1,
2, 3, 5, 6, 7, 8 & 9 OF BLOCK 13 IN HIGH SCHOOL ADDITON PLAT
55

04 206-21-510- -2 Legal Description: SUBSURFACE RIGHTS BELOW 500' IN ALL OF
BLOCK 14 OF HIGH SCHOOL ADDITION PLAT 55

04 206-21-511- -5 Legal Description: SUBSURFACE RIGHTS BELOW 500' IN ALL OF
BLOCK 15 OF HIGH SCHOOL ADDITION PLAT 55

04 206-21-512- -8 Legal Description: SUBSURFACE RIGHTS BELOW 200' HIGH
SCHOOL ADDITION ALL OF BLK 16

04 206-21-513- -1 Legal Description: SUBSURFACE RIGHTS BELOW 500'HIGH
SCHOOL ADDITION ALL BLK 17

04 206-21-514- -4 Legal Description: SUBSURFACE RIGHTS BELOW 500'HIGH
SCHOOL ADDITION ALL OFBLK 18

RECEIVED
BLM AZ STATE OFFICE
2013 OCT 22 A 9:14
PHOENIX, ARIZONA

EXHIBIT B

Any and all interest in and to the following surface rights located in Township 1 North, Ranges 14 and 15 East, Gila and Salt River Meridian, Gila County, Arizona, granted to Bennu Properties, LLC by that certain Judgment dated September 14, 2011, and that certain Partial Judgment dated November 23, 2011, as represented by the following Gila County Assessor Tax Parcel Numbers:

Gila County Assessor Parcel Number	Legal Description
04 206-17-026-C-0	Legal Description: POR OF SW SE NW SEC 30 T1N R15E; THE POR SW OF MIAMI TWN LMTS IN SW SE NW SEC 30; EXC BEG NE COR LT 71 MARS ADD; TH N 36D18' W 166'; TH S 53D42' W 65'; TH S 32D50' E 166.25'; TH N 53D42' E 75' POB; & EXC COM NE COR MAR ADD LT 71; TH N 36D18' W 200' POB; TH N 32D53' W 251.25'; TH N 43D09' W 176.25'; TH N 59D58' W 46.50'; TH ALG A LEFT CURV 76.50'; TH S 33D46' E 43.10'; TH N 52D E 11.10'; TH S 40D54' E 178'; TH S 22D24' E 96.90'; TH S 53D42' W 64.50'; TH S 75D03' E 13.40'; TH S 70D34' E 139.45'; TH N 53D42' E 60.90' POB; EXC BEG SE COR LT 95 RED SPRINGS ADD; TH N 65D54' W 34.40'; TH S 75D03' E 203.50'; TH S 70D34' E 50'; TH S 61D02' E 84.30'; TH S 44D59' E 27.60'; TH S 35D41' W 66.90'; TH N 46D34' W 108.30'; TH S 31D28' W 45.20'; TH N 60D21' W 156'; TH S 68D51' W 57.10'; TH N 26D06' W 86' POB; ALSO EXC ANY PT OF THE ORIG TWST OF MIAMI; RED SPRINGS ADD AND MARS ADD; APPROX 3.29
04 206-18-007- -1	Legal Description: RED SPRINGS ADD LOT 513 BLK 26
04 206-18-062- -0	Legal Description: RED SPRINGS ADD LOT 632 BLK 37
04 206-18-066- -2	Legal Description: RED SPRINGS ADD LOT 640 BLK 37
04 206-18-067- -5	Legal Description: RED SPRINGS ADD LOT 642 BLK 37
04 206-18-068- -8	Legal Description: RED SPRINGS ADD LOT 644 BLK 37
04 206-18-089- -9	Legal Description: RED SPRINGS ADD LOT 116 BLK 38
04 206-18-090- -1	Legal Description: RED SPRINGS ADD LOTS 641 643 BLK 38

RECEIVED
 ELM AZ STATE OFFICE
 2013 OCT 22 9:14

04 206-18-092-A-6 Legal Description: RED SPRINGS ADD ALL OF BLK 39 LESS LOT 89;EXC POR LYING S OF TAX AREA CODE 4000;=0.93 AC M/L (OUT OF 206-18-092)

04 206-18-092-B-5 Legal Description: RED SPRINGS ADD ALL OF BLK 39 LESS LOT 89;EXC POR LYING N OF TAX AREA CODE 4030;=1.32 AC M/L (OUT OF 206-18-092)

04 206-18-093-A-9 Legal Description: RED SPRINGS ADD ALL OF BLK 40;ESC POR LYING S OF TAX AREA CODE 4000;=1.13 AC M/L (OUT OF 206-18-093)

04 206-18-093-B-8 Legal Description: RED SPRINGS ADD ALL OF BLK 40;EXC POR LYING N OF TAX AREA CODE 4030;=0.15 AC M/L (OUT OF 206-18-093)

04 206-18-094- -3 Legal Description: RED SPRINGS ADD LOT 117 BLK 41

04 206-18-095-A-5 Legal Description: RED SPRINGS ADD OF BLK 41 LESS LOT 117;EXC POR LYING S OF TAX AREA CODE 4000;=1.15 AC M/L (OUT OF 206-18-095)

04 206-18-095-B-4 Legal Description: RED SPRINGS ADD ALL OF BLK 41 LESS LOT 117;EXC POR LYING N OF TAX AREA CODE 4030;=0.80 AC M/L (OUT OF 206-18-095)

04 206-18-098- -5 Legal Description: RED SPRINGS ADD LOTS 633 635 637 639 641 643 645 BLK 41

04 206-18-099- -B Legal Description: RED SPRINGS ADD LOT 724 BLK 41

04 206-18-102- -3 Legal Description: RED SPRINGS ADD LOTS 728 730 BLK 41

04 206-18-104- -9 Legal Description: RED SPRINGS ADD LOT 753 BLK 43

04 206-18-105-A-1 Legal Description: LOT 757 AND POR LOT 755 BLK 42 LYING N & W OF SUMMIT AVE;=0.16 AC M/L (OUT OF 206-18-105)

04 206-18-105-B-0 Legal Description: SRLY POR LOT 755 BLK 42;BOUND BY WEST BNDRY OF RED SPRINGS ADD ON WEST AND SUMMIT AVE R/W ON EAST;=0.003 AC M/L(OUT OF 206-18-105)

04 206-18-106- -5 Legal Description: RED SPRINGS ADD LOTS 759 761 763 765

04 206-18-108- -1 Legal Description: RED SPRINGS ADD LOT 751 BLK 43

RECEIVED
 BLM AZ STATE OFFICE
 2012 OCT 22

04 206-18-110- -6 Legal Description: RED SPRINGS ADD LOT 703 LESS W 7' BLK 44

04 206-18-111- -9 Legal Description: RED SPRINGS ADDITION LOTS 705707BLK44

04 206-18-133- -3 Legal Description: RED SPRINGS ADD PCL IN N OF & ADJ TO LOT
722 BLK 44

04-206-18-115- -1 Legal Description: RED SPRINGS ADD W 7' LOT 703; BAL LOT 709
BLK 44 197/103 197/104 310/289

04 206-17-027- -6 Legal Description: PCL OF LAND LYNG N OF MIAMI AVE(ALSO
KNOWN AS MEXICANCANYON) & S OF MIAMI TOWN LIMITS
BNDRY IN SW SE NW SEC 301N 15E

04 206-18-017-A-9 Legal Description: RED SPRINGS ADD LOTS
94,96,98,100,102,104,105,106,108,110,112,114 116,118,120;LOT 122
WITH NE4 OF SW4 SEC 30;EXC THAT POR MYRTLE PAT LODE
MNG CLAIM SITUATE IN SAID SUB ALL IN BLK 28;EXC THAT
POR LYING S OF TAX AREA CODE 4000;=0.41 AC M/L (OUT OF
206-18-017)

04 206-18-017-B-8 Legal Description: RED SPRINGS ADD LOTS
94,96,98,100,102,104,106,108,110,112,114, 116,118,120;LOT 122
WITH NE 4 OF SW4 SEC 30 SEC THAT POR MYRTLE PAT LODE
MNG CLAIM SITUATE IN SAID SUB ALL IN BLK 28;EXC THAT
POR LYING N OF TAX AREA CODE 4030;=0.82 AC M/L(OUT OF
206-18-017)

04 206-18-018- -3 Legal Description: RED SPRINGS ADD LOTS 124 126 128 130 &
FRAC N OF 132 BLK 28

04 206-18-141- -6 Legal Description: SUR RIGHTS IN PCL LYNG E OF KENNEY
DRIVE OF RED SPRINGSADD TO O RIG TWNS OF MIAMI IN SEC
30SW NW T1N R15E

04 206-18-142- -9 Legal Description: PT SW NW SEC 30 T1N R15E; BEG AT NE COR
LOT 120 OF RED SPRINGS ADD; TH N 24D33' W 168.55'; TH S
78D25' E 278.70'; TH S 0D08' W 282.78'; TH N 89D51' W 135.77'; TH
N 19D47' W 196.70' TO POB; APPROX 1.39 AC M/L

RECEIVED
 PLANNING OFFICE
 APR 22 A 9:14

EXHIBIT A

The Property consists of the following described unpatented mining claims situated in the Miami Mining District, Gila County, Arizona, the names of which, the serial numbers assigned by the Arizona State Office of the Bureau of Land Management and the book and page of recording of the location notices thereof in the office of the Gila County Recorder's Office are as follows:

RECEIVED
 BLM AZ STATE OFFICE
 2013 OCT 22 AM 9:14
 PHOENIX, ARIZONA

Claim Name	BLM/ AMC#	Location Date	Gila County #	Section	Township	Range
MIA-1	AMC405285	11/12/2010	2010-012604	29, 30, 31, 32	1 North	15 East
MIA-2	AMC405286	11/12/2010	2010-012605	30, 31	1 North	15 East
MIA-3	AMC405287	11/12/2010	2010-012606	30, 31	1 North	15 East
MIA-4	AMC405288	11/12/2010	2010-012607	30, 31	1 North	15 East
MIA-5	AMC405289	11/12/2010	2010-012608	30, 31	1 North	15 East
MIA-6	AMC405290	11/12/2010	2010-012609	30, 31	1 North	15 East
MIA-7	AMC405291	11/12/2010	2010-012610	30, 31	1 North	15 East
MIA-8	AMC405292	11/12/2010	2010-012611	30, 31	1 North	15 East
MIA-9	AMC405293	11/12/2010	2010-012612	31	1 North	15 East
MIA-10	AMC405294	11/12/2010	2010-012613	31	1 North	15 East
MIA-11	AMC405295	11/14/2010	2010-012647	31	1 North	15 East
MIA-12	AMC405296	11/14/2010	2010-012648	31	1 North	15 East
MIA-13	AMC405297	11/12/2010	2010-012614	31, 36	1 North	15 East, 14 East
MIA-14	AMC405298	11/12/2010	2010-012615	31	1 North	15 East
MIA-15	AMC405299	11/12/2010	2010-012616	31	1 North	15 East
MIA-16	AMC405300	11/14/2010	2010-012649	31	1 North	15 East
MIA-17	AMC405301	11/14/2010	2010-012650	31	1 North	15 East
MIA-18	AMC405302	11/12/2010	2010-012617	31, 36	1 North	15 East, 14 East
MIA-19	AMC405303	11/12/2010	2010-012651	31, 1	1 North, 1 South	15 East, 14 East
MIA-20	AMC405304	11/12/2010	2010-012652	31, 1	1 North, 1 South	15 East, 14 East
MIA-21	AMC405305	11/13/2010	2010-012653	31, 1	1 North, 1 South	15 East, 14 East
MIA-22	AMC405306	11/13/2010	2010-012654	31, 1	1 North, 1 South	15 East, 14 East
MIA-23	AMC405307	11/13/2010	2010-012655	31, 36, 1	1 North, 1 North, 1 South	15 East, 14 East, 14 East
MIA-24	AMC405308	11/13/2010	2010-012656	36, 1, 2	1 North, 1 South	14 East

MIA-25	AMC405309	11/13/2010	2010-012657	36, 1, 2	1 North, 1 South	14 East
MIA-26	AMC405310	11/13/2010	2010-012658	36, 1, 2	1 North, 1 South	14 East
MIA-27	AMC405311	11/13/2010	2010-012659	36, 1	1 North, 1 South	14 East
MIA-28	AMC405312	11/13/2010	2010-012660	36, 1	1 North, 1 South	14 East
MIA-29	AMC405313	11/13/2010	2010-012661	36, 1	1 North, 1 South	14 East
MIA-30	AMC405314	11/13/2010	2010-012662	36, 1	1 North, 1 South	14 East
MIA-31	AMC405315	11/13/2010	2010-012663	36, 1	1 North, 1 South	14 East
MIA-32	AMC405316	11/14/2010	2010-012664	36	1 North	14 East
MIA-33	AMC405317	11/14/2010	2010-012665	36	1 North	14 East
MIA-34	AMC405318	11/14/2010	2010-012666	36	1 North	14 East
MIA-35	AMC405319	11/12/2010	2010-012618	36	1 North	14 East

I:\FILES\DOCS\BELL19\120696\DOC\MU6532.DOC

RECEIVED
 RIMMERS SERVICE
 2011 OCT 22 A 9:14

EXHIBIT B
Articles of Amendment
[attached]

RECEIVED
BLM AZ STAFF OFFICE

2013 OCT 22 A 9 14

PHOENIX, ARIZONA



AZ CORPORATION COMMISSION
FILED

AUG 28 2013

FILE NO: 1779101-3

DO NOT WRITE ABOVE THIS LINE; RESERVE FOR ACC USE ONLY.

**ARTICLES OF AMENDMENT
FOR-PROFIT CORPORATION**
Read the Instructions C014

1. **ENTITY NAME** - give the exact name of the corporation as currently shown in A.C.C. records:
Copper Fox Van Dyke Co.

2. **A.C.C. FILE NUMBER:** 17791013
Find the A.C.C. file number on the upper corner of filed documents OR on our website at: <http://www.azcc.com/OnlineCorporations>

3. **Date on which the attached amendment was adopted:** 08/22/2013

4. **Does the amendment provide for an exchange, reclassification or cancellation of issued shares?**
 Yes - go to number 4.1 and continue. No - go to number 5 and continue.

4.1 **If your answer to number 4 was "yes," does the amendment contain provisions for implementing the exchange, reclassification or cancellation of issued shares?**
 Yes - go to number 5 and continue. No - go to number 4.2 and continue.

4.2 **If your answer to number 4.1 was "no," you must provide a statement of the provisions for implementing the exchange, reclassification or cancellation of issued shares - attach a separate sheet with the statement.**

5. **Check one box concerning approval of the amendment and follow instructions (review the Instructions C014 for information about voting groups):**

- Approved by incorporators or board of directors without shareholder action, and shareholder approval was not required or no shares have been issued- go to number 6.
- Approved by shareholders but not voting groups - complete numbers 5.1 and 5.2.
- Approved by shareholders and voting groups - complete numbers 5.1, 5.2, and 5.3.
- Approved by voting group(s) only - complete numbers 5.1 and 5.3.

5.1 **Shares** - list below each class and/or series of shares and the total number of outstanding shares for each class or series (example: common stock, 100 shares). If more space is needed, check this box and complete and attach the Shares Issued Attachment form C097.

Class	Series	Total
Common	0	100

RECEIVED
BLM AZ STATE OFFICE

2013 OCT 22 A 9:14

5.2 Shareholder approval (all blanks must be filled in):

Total votes entitled to be cast	Votes in favor that were sufficient for approval of amendments	Votes against amendments
100	100	0

5.3 Voting Groups - complete each blank below for each voting group. Review the Instructions C014 for information about voting groups. If more space is needed, check this box, and complete and attach the Voting Attachment form C069.

Voting Group (class / series)	Total votes in voting group	Disputable votes of meeting	Votes in favor that were sufficient for approval of amendments	Votes against amendments

6. A copy of the corporation's amendment must be attached to these Articles.

SIGNATURE: By checking the box marked "I accept" below, I acknowledge under penalty of perjury that this document together with any attachments is submitted in compliance with Arizona law.

I ACCEPT

Catherine Henderson

Catherine Henderson

AUGUST 22, 2013

REQUIRED - check only one:

<input type="checkbox"/> I am the Chairman of the Board or Director of the corporation filing this document.	<input checked="" type="checkbox"/> I am a duly authorized Officer of the corporation filing this document.	<input type="checkbox"/> I am a duly authorized Secretary, trustee, receiver, or other court-appointed fiduciary for the corporation filing this document.
--	---	--

Filing Fee: \$25.00 (regular processing) Expedited processing - add \$35.00 to filing fee. All fees are non-refundable - see instructions.	Mail: Arizona Corporation Commission - Corporate Filings Section 1300 W. Washington St., Phoenix, Arizona 85007 Fax: 602-542-4100
--	---

Please be advised that A.C.C. forms reflect only the minimum provisions required by statute. You should seek private legal counsel for those matters that may pertain to the individual needs of your business.
All documents filed with the Arizona Corporation Commission are public records and are open for public inspection.
If you have questions after reading the instructions, please call 602-542-3026 or (within Arizona only) 800-245-5889.

RECEIVED
BLM AZ STATE OFFICE
2013 OCT 22 A 9:15
PHOENIX, ARIZONA

100 20 2013 12:00 PM ORDER FOR RECEIPT BY 24081234 TO 0200014

EXHIBIT A

**AMENDMENT TO THE
ARTICLES OF INCORPORATION OF
COPPER FOX VAN DYKE CO.**

Article "First" of the Articles of Incorporation is hereby amended to read as follows:

"FIRST: The name of the Corporation is Desert Fox Van Dyke Co."

RECEIVED

2013 OCT 22 A 9:15

DLM AZ STATE OFFICE

11015003.1

Snell & Wilmer

L.L.P.
LAW OFFICES

One South Church Avenue
Suite 1500
Tucson, Arizona 85701-1630
520.882.1200
520.884.1294 (Fax)
www.swlaw.com

James P. Allen, Esq.
(801) 257-1956
jpalen@swlaw.com

September 18, 2013

United States Department of the Interior
Bureau of Land Management
Attn: Adjudicator
Arizona State Office
One North Central Avenue
Suite 800
Phoenix, Arizona 84005-4427

RECEIVED
BLM AZ STATE OFFICE
2013 OCT 22 A 9:15
PHOENIX, ARIZONA

RE: Copper Fox Sombrero Butte Co.

Dear Sir or Madam:

This Firm represents Copper Fox Sombrero Butte Co. (the "Corporation"), which is the owner of 38 unpatented mining claims located in Pinal County, Arizona, as set forth on the attached Exhibit A.

This letter is to notify the Department that the Corporation has changed its name to Desert Fox Sombrero Butte Co. A copy of the approved name change from the Arizona Corporation Commission is attached as Exhibit B.

Please contact me at (801) 257-1959 if you have any questions or need anything further to complete the transfer.

Very truly yours,

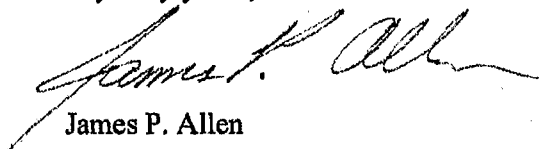

James P. Allen

JPA:jmc
Enclosures

EXHIBIT A

The Property consists of the following described unpatented mining claims situated in the Bunker Hill Mining District, Pinal County, Arizona, the names of which, the serial numbers assigned by the Arizona State Office of the Bureau of Land Management and the book and page of recording of the location notices thereof in the office of the Pinal County Recorder's Office.

PHOTOGRAPHY DIVISION

2013 OCT 22 A 9 15

RECEIVED
BLM AZ STATE OFFICE

Claim Name	BLM/ AMC#	Filing Date	Pinal County Fee #	Section	Township	Range
Max 5	371538	4/21/2006	2006-031771	23	8 South	18 East
Max 6	371539	4/21/2006	2006-031772	23	8 South	18 East
Max 7	371540	4/21/2006	2006-031773	23	8 South	18 East
Max 8	371541	4/21/2006	2006-031774	23	8 South	18 East
Max 9	371542	4/21/2006	2006-031775	23	8 South	18 East
Max 10	371543	4/21/2006	2006-031776	23	8 South	18 East
Max 11	371544	4/21/2006	2006-031777	23	8 South	18 East
Max 12	371545	4/21/2006	2006-031778	23	8 South	18 East
Max 13	371546	4/21/2006	2006-031779	23	8 South	18 East
Max 14	371547	4/21/2006	2006-031780	23	8 South	18 East
Max 15	371548	4/21/2006	2006-031781	23	8 South	18 East
Max 16	371549	4/21/2006	2006-031782	23	8 South	18 East
Max 17	371550	4/21/2006	2006-031783	23	8 South	18 East
Max 18	371551	4/21/2006	2006-031784	23	8 South	18 East
Max 19	371552	4/21/2006	2006-031785	23	8 South	18 East
Max 20	371553	4/21/2006	2006-031786	23	8 South	18 East
Max 21	371554	4/21/2006	2006-031787	23	8 South	18 East
Max 22	371555	4/21/2006	2006-031788	23	8 South	18 East
Max 23	371556	4/21/2006	2006-031789	23	8 South	18 East
Max 24	371557	4/21/2006	2006-031790	23	8 South	18 East
Max 25	371558	4/21/2006	2006-031791	23	8 South	18 East
Max 26	371559	4/21/2006	2006-031792	23	8 South	18 East
Max 27	371560	4/21/2006	2006-031793	23	8 South	18 East
Max 28	371561	4/21/2006	2006-031794	23	8 South	18 East
Max 29	371562	4/21/2006	2006-031795	23	8 South	18 East
Max 30	371563	4/21/2006	2006-031796	23	8 South	18 East
Max 31	371564	4/21/2006	2006-031797	23	8 South	18 East
Max F1	371533	4/21/2006	2006-027209	23	8 South	18 East
Max F2	371534	4/21/2006	2006-027210	23	8 South	18 East
Max F3	371535	4/21/2006	2006-027211	23	8 South	18 East
Max F4	371536	4/21/2006	2006-027212	23	8 South	18 East
Max F5	371537	4/21/2006	2006-027213	23	8 South	18 East

371533 - 371564

AMY 7	396287	12/16/2008	2008-119817	26	8 South	18 East
AMY 9	396288	12/16/2008	2008-119819	26	8 South	18 East
AMY 11	396289	12/16/2008	2008-119821	26	8 South	18 East
AMY 13	396290	12/16/2008	2008-119823	26	8 South	18 East
AMY 15	396291	12/16/2008	2008-119825	26	8 South	18 East
AMY 17	396292	12/16/2008	2008-119827	26	8 South	18 East

38

\\FILES\DOCS\BELL19\120698\DOCMU3553.DOC

RECEIVED
BLM AZ STATE OFFICE
2012 OCT 22 A 9:15
TERRILL, ARIZONA

396287-396292

6 of

AMC 357560 AMC 358746
 357853 359987
 357871
 357873 360058
 358032
 358745

EXHIBIT A

The Property consists of the following described unpatented mining claims (Part I) and patented mining claims (Part II) situated in the Bunker Hill Mining District, Pinal County, Arizona (Gila & Salt River Meridian).

RECEIVED
 BLM AZ STATE OFFICE
 2013 OCT 22 A 9:16
 PINAL COUNTY ARIZONA

Part I: Unpatented Mining Claims:

Claim Name	BLM Serial No.	Filing Date	Section	Township	Range
Magma Chief Ext.	AMC357560	3/5/2003	23	8 South	18 East
Battle Axe	AMC357561	3/5/2003	23	8 South	18 East
Kin Sabie	AMC357562	3/5/2003	23	8 South	18 East
Sunset	AMC357853	4/11/2003	23	8 South	18 East
Jewel	AMC357854	4/11/2003	23	8 South	18 East
Hot Foot Johnny	AMC357871	4/11/2003	23	8 South	18 East
Bagdad MS3601	AMC357873	4/28/2003	23	8 South	18 East
Copper Reef No. 2	AMC357874	4/28/2003	23	8 South	18 East
Copper Ridge	AMC358745	10/10/2003	23	8 South	18 East
Copper Ridge 1	AMC358746	10/10/2003	23	8 South	18 East
Lookout MS3601	AMC358032	5/12/2003	23	8 South	18 East
Sunday	AMC357875	4/28/2003	23	8 South	18 East
Sunset 1	AMC359987	2/5/2004	23	8 South	18 East
Sunset 2	AMC359988	2/5/2004	23	8 South	18 East
Sunset 3	AMC359989	2/5/2004	23	8 South	18 East
Copper Triangle	AMC360058	2/16/2004	23	8 South	18 East
Red Mountain	AMC359990	2/5/2004	23	8 South	18 East

Part II: Patented Claims:

Name	Patent No.	M.S. No.	Pinal County Parcel No.	Section	Township	Range
Audacious Lode	845725	3602	306-31-0030	23	8 South	18 East
Grand Duke	647064	3272	306-31-0020	14, 23	8 South	18 East
Gulch Copper	647064	3272	306-31-0020	14, 23	8 South	18 East

17 claims belong to Silver Nickel cannot transfer earn with 398 code

*Letter - #11
 Trans cannot be transferred on 17 claims*

money earned on 398 code

*357560 - 562
 357853 - 854
 357871 -
 357873 - 875
 358745 - 746
 358032
 359987 - 990
 360058*

EXHIBIT B
Articles of Amendment
[attached]

RECEIVED
BLM AZ STATE OFFICE

2013 OCT 22 A 9:15

PHOENIX, ARIZONA



04366215

**AZ CORPORATION COMMISSION
FILED**

AUG 26 2013

FILE NO-1779104-6

RECEIVED
BLM AZ STATE OFFICE

2013 OCT 22 A 9: 5

PHOENIX, ARIZONA

DO NOT WRITE ABOVE THIS LINE RESERVED FOR ACC USE ONLY.

**ARTICLES OF AMENDMENT
FOR-PROFIT CORPORATION**
Read the Instructions C0141

1. **ENTITY NAME** - give the exact name of the corporation as currently shown in A.C.C. records:

Copper Fox Sombrero Bullo Co.

2. **A.C.C. FILE NUMBER:** 17791046

Find the A.C.C. file number on the upper corner of filed documents OR on our website at: <http://www.azcc.gov/Division/Corporations>

3. Date on which the attached amendment was adopted: 08/22/2013

4. Does the amendment provide for an exchange, reclassification or cancellation of issued shares?
 Yes - go to number 4.1 and continue. No - go to number 5 and continue.

4.1 If your answer to number 4 was "yes," does the amendment contain provisions for implementing the exchange, reclassification or cancellation of issued shares?
 Yes - go to number 5 and continue. No - go to number 4.2 and continue.

4.2 If your answer to number 4.1 was "no," you must provide a statement of the provisions for implementing the exchange, reclassification or cancellation of issued shares - attach a separate sheet with the statement.

5. Check one box concerning approval of the amendment and follow instructions (review the Instructions C0141 for information about voting groups):

- Approved by incorporators or board of directors without shareholder action, and shareholder approval was not required or no shares have been issued- go to number 6.
- Approved by shareholders but not voting groups - complete numbers 5.1 and 5.2.
- Approved by shareholders and voting groups - complete numbers 5.1, 5.2, and 5.3.
- Approved by voting group(s) only - complete numbers 5.1 and 5.3.

5.1 Shares - list below each class and/or series of shares and the total number of outstanding shares for each class or series (example: common stock, 100 shares). If more space is needed, check this box and complete and attach the Shares Issued Attachment form C097.

Class: Common	Shares: 0	Total: 100
Class:	Shares:	Total:
Class:	Shares:	Total:
Class:	Shares:	Total:
Class:	Shares:	Total:

RECEIVED
BLMAZ STATE OFFICE
2013 OCT 22 A 9:15
PHOENIX, ARIZONA

5.2 Shareholder approval (all blanks must be filled in):

Total votes entitled to be cast	Votes in favor that were sufficient for approval of amendments	Votes against amendments
100	100	0

5.3 Voting Groups -- complete each blank below for each voting group. Review the Instructions, CO13, for information about voting groups. If more space is needed, check this box, and complete and attach the Voting Attachment form CO89.

Voting Groups (class / votes)	Total votes in voting group	Indisputable votes at meeting	Votes in favor that were sufficient for approval of amendments	Votes against amendments

6. A copy of the corporation's amendment must be attached to these Articles.

SIGNATURE: By checking the box marked "I accept" below, I acknowledge under penalty of perjury that this document together with any attachments is submitted in compliance with Arizona law.

I ACCEPT

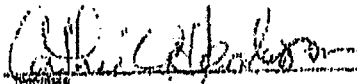
 Catherine Henderson August 27, 2013

REQUIRED - check only one:

<input type="checkbox"/> I am the Chairman of the Board or Director of the corporation filing this document.	<input checked="" type="checkbox"/> I am a duly-authorized Officer of the corporation filing this document.	<input type="checkbox"/> I am a duly authorized bankruptcy trustee, receiver, or other court-appointed fiduciary for the corporation filing this document.
--	---	--

Filing Fee: \$75.00 (regular processing) Expedited processing - add \$35.00 to filing fee. All fees are non-refundable - see instructions.	Mail: Arizona Corporation Commission - Corporate Filings Section 1300 W. Washington St., Phoenix, Arizona 85007 Fax: 602-342-4100
--	---

Some or all of the A.C.C. forms collect only the minimum provision required by statute. You should seek private legal counsel for those matters that may pertain to the individual needs of your business. All documents filed with the Arizona Corporation Commission are public records and are open for public inspection. If you have any questions about reading the instructions, please call (414) 343-3078 or (within Arizona only) 800-345-5839.

08/26/2013 09:01 6025420810
08/26/2013 13:41 5208841294

ACC
SNELLAWILMER

PAGE 05/05
PAGE 05/05

EXHIBIT A

**AMENDMENT TO THE
ARTICLES OF INCORPORATION OF
COPPER FOX SOMBRERO BUTTE CO.**

Article "First" of the Articles of Incorporation is hereby amended to read as follows:

"FIRST: The name of the Corporation is Desert Fox Sombbrero Butte Co."

PHOENIX, ARIZONA

2013 OCT 22 A 9:15

RECEIVED
BLM AZ STATE OFFICE

**United States Department of the Interior
Bureau of Land Management
LANDS/RECREATION & PLANNING
ONE N CENTRAL AVE
PHOENIX, AZ 85004 -2203
Phone: 602-417-9200**

Receipt

No: 2892975

Transaction #: 2979423	ENTERED INTO COMPUTER
Date of Transaction: 10/23/2013	
CUSTOMER:	
SNELL & WILMER LLP 1 S CHURCH AVE STE 1500 TUCSON, AZ 85701-1630 US	

LINE #	QTY	DESCRIPTION	REMARKS	UNIT PRICE	TOTAL
1	1.00	LOCATABLE MINERALS / MINING CLAIMS- NOT NEW-UNADJUD, ONE AUTH NO. ONLY / MINING CLAIM MONEY RECEIVED CASES: AMC405285/\$900.00	TRF - 73	- n/a -	900.00
TOTAL:					\$900.00

PAYMENT INFORMATION					
1	AMOUNT:	900.00	POSTMARKED:	10/21/2013	
	TYPE:	CHECK	RECEIVED:	10/22/2013	
	CHECK NO:	12094			
	NAME:	SNELL WILMER LLP 1 S CHURCH AVE STE 1500 TUCSON AZ 85701-1630 US			

REMARKS

This receipt was generated by the automated BLM Collections and Billing System and is a paper representation of a portion of the official electronic record contained therein.

One South Church Avenue
Suite 1500
Tucson, Arizona 85701-1630
520.882.1200
520.884.1294 (Fax)
www.swlaw.com

Lowell E. Thomas
520.882.1221
lthomas@swlaw.com

September 6, 2012

371533
396287 DENVER
LAS VEGAS
LOS ANGELES
LOS CABOS
ORANGE COUNTY
PHOENIX
RENO
SALT LAKE CITY
TUCSON

NO. OF CLAIMS 38
AMOUNT 380
RECEIPT NO. 2651671
INIT. SC

**** BLM-ASO****

VIA HAND DELIVERY

BLM Arizona State Office
One North Central Ave, Suite 800
Phoenix, Arizona 8500-4427

Re: Notice of Transfer of Interest

Dear Sir or Madam:

On behalf of Copper Fox Sombrero Butte Co., an Arizona Corporation, whose address is 340-12th Ave. SW, Suite 650, Calgary, Alberta, Canada T2R 1L5, we are submitting this Notice of Transfer of Interest pursuant to 43 C.F.R. § 3833.32 for the following unpatented mining claims located in Pinal County, Arizona:

Please see Exhibit A attached

Enclosed is a true and correct copy of the Mining Deed, dated August 30, 2012, from Bell Resources (NEVADA) Corporation, conveying title to thirty-eight (38) unpatented mining claims to Copper Fox Sombrero Butte Co.

If you have any question concerning this request, please feel free to contact me. Thank you for your assistance.

Sincerely,

SNELL & WILMER L.L.P.

Lowell E. Thomas

RECEIVED
BLM AZ STATE OFFICE
2012 SEP -6 P 2:51
PHOENIX, ARIZONA

Enclosures

ENTERED INTO COMPUTER

10/4/2012

RECEIVED
 BLM AZ STATE OFFICE
 2012 SEP - 6 P 2:54
 PHOENIX, ARIZONA

EXHIBIT A

The Property consists of the following described unpatented mining claims situated in the Bunker Hill Mining District, Pinal County, Arizona, the names of which, the serial numbers assigned by the Arizona State Office of the Bureau of Land Management and the book and page of recording of the location notices thereof in the office of the Pinal County Recorder's Office.

Claim Name	BLM/ AMC#	Filing Date	Pinal County Fee#	Section	Township	Range
Max 5	371538	4/21/2006	2006-031771	23	8 South	18 East
Max 6	371539	4/21/2006	2006-031772	23	8 South	18 East
Max 7	371540	4/21/2006	2006-031773	23	8 South	18 East
Max 8	371541	4/21/2006	2006-031774	23	8 South	18 East
Max 9	371542	4/21/2006	2006-031775	23	8 South	18 East
Max 10	371543	4/21/2006	2006-031776	23	8 South	18 East
Max 11	371544	4/21/2006	2006-031777	23	8 South	18 East
Max 12	371545	4/21/2006	2006-031778	23	8 South	18 East
Max 13	371546	4/21/2006	2006-031779	23	8 South	18 East
Max 14	371547	4/21/2006	2006-031780	23	8 South	18 East
Max 15	371548	4/21/2006	2006-031781	23	8 South	18 East
Max 16	371549	4/21/2006	2006-031782	23	8 South	18 East
Max 17	371550	4/21/2006	2006-031783	23	8 South	18 East
Max 18	371551	4/21/2006	2006-031784	23	8 South	18 East
Max 19	371552	4/21/2006	2006-031785	23	8 South	18 East
Max 20	371553	4/21/2006	2006-031786	23	8 South	18 East
Max 21	371554	4/21/2006	2006-031787	23	8 South	18 East
Max 22	371555	4/21/2006	2006-031788	23	8 South	18 East
Max 23	371556	4/21/2006	2006-031789	23	8 South	18 East
Max 24	371557	4/21/2006	2006-031790	23	8 South	18 East
Max 25	371558	4/21/2006	2006-031791	23	8 South	18 East
Max 26	371559	4/21/2006	2006-031792	23	8 South	18 East
Max 27	371560	4/21/2006	2006-031793	23	8 South	18 East
Max 28	371561	4/21/2006	2006-031794	23	8 South	18 East
Max 29	371562	4/21/2006	2006-031795	23	8 South	18 East
Max 30	371563	4/21/2006	2006-031796	23	8 South	18 East
Max 31	371564	4/21/2006	2006-031797	23	8 South	18 East
Max F1	371533	4/21/2006	2006-027209	23	8 South	18 East
Max F2	371534	4/21/2006	2006-027210	23	8 South	18 East
Max F3	371535	4/21/2006	2006-027211	23	8 South	18 East
Max F4	371536	4/21/2006	2006-027212	23	8 South	18 East
Max F5	371537	4/21/2006	2006-027213	23	8 South	18 East
AMY 7	396287	12/16/2008	2008-119817	26	8 South	18 East
AMY 9	396288	12/16/2008	2008-119819	26	8 South	18 East
AMY 11	396289	12/16/2008	2008-119821	26	8 South	18 East
AMY 13	396290	12/16/2008	2008-119823	26	8 South	18 East

When recorded, return to:

Lowell E. Thomas
Snell & Wilmer L.L.P.
One South Church Avenue, Suite 1500
Tucson , Arizona 85701-1630

Exempt per A.R.S. § 11-1134.A.6

MINING DEED
(With special warranties of possessory title)

FOR GOOD AND VALUABLE CONSIDERATION, the receipt and sufficient of which are hereby expressly acknowledged, **BELL RESOURCES (NEVADA) CORPORATION**, Nevada corporation ("Grantor"), does, subject to the paramount right and title of the United States of America and the limitations under the General Mining Law, hereby convey to **COPPER FOX SOMBRERO BUTTE CO.**, an Arizona corporation, whose address is 340-12th Ave. SW, Suite 650, Calgary, Alberta, Canada T2R 1L5 ("Grantee"), those certain unpatented lode mining claims situated in the Copper Creek Mining District, Pinal County, Arizona (the "Property"), the names of which, the place of record of the location notices thereof in the official records of Pinal County and the serial numbers assigned by the Arizona State Office of the Bureau of Land Management, are set forth in Exhibit A attached hereto and made a part hereof.

TOGETHER WITH any and all extralateral and other associated rights, water rights, tenements, hereditaments and appurtenances thereto belonging or otherwise appertaining thereto.

SUBJECT TO:

1. Current and existing taxes, if any, and all other matters of record and such matters as an accurate survey or visual inspection of the Property would disclose;
2. Paramount title of the United States;
3. All existing roads, rights-of-way and easements of record in the office of the recorder of Pinal County, Arizona, and the Arizona State Office of the Bureau of Land Management;
4. All leases, permits, approvals and other rights heretofore or hereafter granted by the United States in its administration of its paramount title;
5. The effect of conflicts and overlaps (if any) between the above-described mining claims and adjoining mining claims owned by third parties;

AMY 15	396291	12/16/2008	2008-119825	26	8 South	18 East
AMY 17	396292	12/16/2008	2008-119827	26	8 South	18 East

RECEIVED
BLM AZ STATE OFFICE
2012 SEP -6 P 2:51
PHOENIX, ARIZONA

2/kc

RECEIVED
 BLM AZ STATE OFFICE
 2012 SEP -6 P 2:11
 PHOENIX, ARIZONA

EXHIBIT A

The Property consists of the following described unpatented mining claims situated in the Bunker Hill Mining District, Pinal County, Arizona, the names of which, the serial numbers assigned by the Arizona State Office of the Bureau of Land Management and the book and page of recording of the location notices thereof in the office of the Pinal County Recorder's Office.

Claim Name	BLM/ AMC#	Filing Date	Pinal County Fee #	Section	Township	Range
Max 5	371538	4/21/2006	2006-031771	23	8 South	18 East
Max 6	371539	4/21/2006	2006-031772	23	8 South	18 East
Max 7	371540	4/21/2006	2006-031773	23	8 South	18 East
Max 8	371541	4/21/2006	2006-031774	23	8 South	18 East
Max 9	371542	4/21/2006	2006-031775	23	8 South	18 East
Max 10	371543	4/21/2006	2006-031776	23	8 South	18 East
Max 11	371544	4/21/2006	2006-031777	23	8 South	18 East
Max 12	371545	4/21/2006	2006-031778	23	8 South	18 East
Max 13	371546	4/21/2006	2006-031779	23	8 South	18 East
Max 14	371547	4/21/2006	2006-031780	23	8 South	18 East
Max 15	371548	4/21/2006	2006-031781	23	8 South	18 East
Max 16	371549	4/21/2006	2006-031782	23	8 South	18 East
Max 17	371550	4/21/2006	2006-031783	23	8 South	18 East
Max 18	371551	4/21/2006	2006-031784	23	8 South	18 East
Max 19	371552	4/21/2006	2006-031785	23	8 South	18 East
Max 20	371553	4/21/2006	2006-031786	23	8 South	18 East
Max 21	371554	4/21/2006	2006-031787	23	8 South	18 East
Max 22	371555	4/21/2006	2006-031788	23	8 South	18 East
Max 23	371556	4/21/2006	2006-031789	23	8 South	18 East
Max 24	371557	4/21/2006	2006-031790	23	8 South	18 East
Max 25	371558	4/21/2006	2006-031791	23	8 South	18 East
Max 26	371559	4/21/2006	2006-031792	23	8 South	18 East
Max 27	371560	4/21/2006	2006-031793	23	8 South	18 East
Max 28	371561	4/21/2006	2006-031794	23	8 South	18 East
Max 29	371562	4/21/2006	2006-031795	23	8 South	18 East
Max 30	371563	4/21/2006	2006-031796	23	8 South	18 East
Max 31	371564	4/21/2006	2006-031797	23	8 South	18 East
Max F1	371533	4/21/2006	2006-027209	23	8 South	18 East
Max F2	371534	4/21/2006	2006-027210	23	8 South	18 East
Max F3	371535	4/21/2006	2006-027211	23	8 South	18 East
Max F4	371536	4/21/2006	2006-027212	23	8 South	18 East
Max F5	371537	4/21/2006	2006-027213	23	8 South	18 East

371533 - 371564

396287- 396292³

9/6/12
2651671

Grantor hereby binds itself and its successors to warrant and defend its possessory title, as against all acts of the Grantor herein and no other, subject to the matters set forth above.

30th IN WITNESS WHEREOF, Grantor has executed this Mining Deed on this day of August, 2012.

GRANTOR:

BELL RESOURCES (NEVADA) CORPORATION

By: *Timothy Marsh*
Timothy Marsh, Vice-President

STATE OF ARIZONA)
)
County of) ss.

On this, the 30th day of August, 2012, before me, the undersigned Notary Public, personally appeared Timothy Marsh, the Vice-President of Bell Resources (Nevada) Corporation, a Nevada corporation, the Grantor herein, for and on behalf of the corporation.

Robin E Barnes
Notary Public

My Commission Expires:

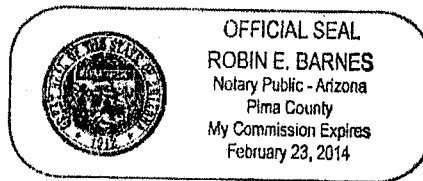

RECEIVED
BLM AZ STATE OFFICE
2012 SEP -6 P 2:51
PHOENIX, ARIZONA

AMY 7	396287	12/16/2008	2008-119817	26	8 South	18 East
AMY 9	396288	12/16/2008	2008-119819	26	8 South	18 East
AMY 11	396289	12/16/2008	2008-119821	26	8 South	18 East
AMY 13	396290	12/16/2008	2008-119823	26	8 South	18 East
AMY 15	396291	12/16/2008	2008-119825	26	8 South	18 East
AMY 17	396292	12/16/2008	2008-119827	26	8 South	18 East

I:\FILES\DOCS\BELL19\120696\DOC\MU3553.DOC

RECEIVED
BLM AZ STATE OFFICE
2012 SEP -6 P 2:51
PHOENIX, ARIZONA

United States Department of the Interior
 Bureau of Land Management
 LANDS/RECREATION & PLANNING
 ONE N CENTRAL AVE
 PHOENIX, AZ 85004 -2203
 Phone: 602-417-9200

Receipt

No: 2651671

Transaction #: 2732484	
Date of Transaction: 09/06/2012	
CUSTOMER:	
COPPER FOX VAN DYKE CO 340 12TH AVE #650 CALGARY ALBERTA CANADA,NS T2R 1L5 CA	

LINE #	QTY	DESCRIPTION	REMARKS	UNIT PRICE	TOTAL
1	1.00	LOCATABLE MINERALS / MINING CLAIMS-NOT NEW-UNADJUD,ONE AUTH NO. ONLY / MINING CLAIM MONEY RECEIVED CASES: AMC405285/\$730.00	TRF (73)	- n/a -	730.00
TOTAL:					\$730.00

PAYMENT INFORMATION					
1	AMOUNT:	730.00	POSTMARKED:	N/A	
	TYPE:	CHECK	RECEIVED:	09/06/2012	
	CHECK NO:	3695			
	NAME:	MEAD, DANIEL 11280 N SHADOW VISTA PL TUCSON AZ 85742 CA			

REMARKS

This receipt was generated by the automated BLM Collections and Billing System and is a paper representation of a portion of the official electronic record contained therein.

DR



OFFICIAL RECORDS OF
PINAL COUNTY RECORDER
LAURA DEAN-LYTLE

DATE/TIME: 04/17/2012 1153
FEE: \$9.00
PAGES: 2
FEE NUMBER: 2012-031698



After recording, please return to:

Timothy M. Marsh
4750 North Bonanza Avenue
Tucson, AZ 85749

Exempt pursuant to §A.R.S. 11-1134.B.2

RECEIVED
BLM/AZ STATE OFFICE
2012 APR 18 A 9:56
PHOENIX, ARIZONA

QUITCLAIM DEED

For the consideration of Ten Dollars (\$10.00) and other valuable considerations, I, **TIM MARSH dba BELL RESOURCES CORPORATION-US**, hereby quitclaim to **BELL RESOURCES (NEVADA) CORPORATION**, a Nevada corporation, whose address is 4750 North Bonanza Avenue, Tucson, AZ 85749, all right, title or interest in those certain unpatented mining claims situated in the Bunker Hill (Copper Creek) Mining District, Pinal County, Arizona, the names of which and the place of record of the location notices thereof are in the official records of said County and the Arizona State Office of the Bureau of Land Management as set forth in Exhibit A attached hereto and incorporated herein by this reference.

Dated this 17th day of April, 2012.

Timothy M. Marsh
dba Bell Resources Corporation-US

STATE OF ARIZONA)
) ss.
County of Pima)

The foregoing instrument was acknowledged before me this 17th day of April, 2012, by Timothy M. Marsh dba Bell Resources Corporation-US.

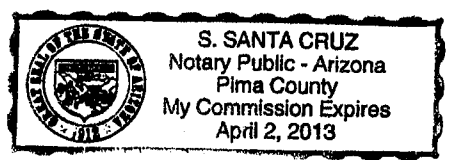

Notary Public

b/bc

EXHIBIT A

The Property quitclaimed hereby consists of the following described unpatented mining claims situated in the Bunker Hill (Copper Creek) Mining District, Pinal County, Arizona, the names of which, the serial numbers assigned by the Arizona State Office of the Bureau of Land Management and the fee number assigned for recording of the location notices thereof in the office of the Recorder of Pinal County, Arizona, are as follows:

Claim Name	BLM/ AMC#	Filing Date	Pinal County Fee #	Section	Township	Range
AMY 7	396287	12/16/2008	2008-119817	26	8 South	18 East
AMY 9	396288	12/16/2008	2008-119819	26	8 South	18 East
AMY 11	396289	12/16/2008	2008-119821	26	8 South	18 East
AMY 13	396290	12/16/2008	2008-119823	26	8 South	18 East
AMY 15	396291	12/16/2008	2008-119825	26	8 South	18 East
AMY 17	396292	12/16/2008	2008-119827	26	8 South	18 East

I:\FILES\DOCS\BELL19\110351\DOC\MD2935.DOC

PHOENIX, ARIZONA

2012 APR 18 A 9:51

RECORDED
BLM & STATE OFFICE

United States Department of the Interior
 Bureau of Land Management
 LANDS/RECREATION & PLANNING
 ONE N CENTRAL AVE
 PHOENIX, AZ 85004 -2203
 Phone: 602-417-9200

Receipt

No: 2552089

Transaction #: 2631008	
Date of Transaction: 04/18/2012	
CUSTOMER:	
TIMOTHY MARSH 4750 N BONANZA AVE TUCSON, AZ 85749-8293 US	

LINE #	QTY	DESCRIPTION	REMARKS	UNIT PRICE	TOTAL
1	1.00	LOCATABLE MINERALS / MINING CLAIMS-NOT NEW-UNADJUD, ONE AUTH NO. ONLY / MINING CLAIM MONEY RECEIVED CASES: AMC396287/\$60.00	TRF (6)	- n/a -	60.00
TOTAL:					\$60.00

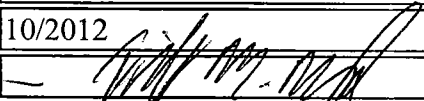
PAYMENT INFORMATION			
NOTE: Items will appear on credit card statement as "Bureau of Land Mgmt CO".			
1	AMOUNT:	60.00	POSTMARKED: N/A
	TYPE:	CREDIT CARD	RECEIVED: 04/18/2012
	NAME:	MARSH, TIMOTHY 4750 N BONANZA AVE TUCSON AZ 85749-8293 US	
	CARD NO:	XXXXXXXXXXXX2777	AUTH CODE: 05560C
	NAME ON CARD:	TIMOTHY M MARSH	
	EXPIRES:	10/2012	
	SIGNATURE:		

REMARKS

This receipt was generated by the automated BLM Collections and Billing System and is a paper representation of a portion of the official electronic record contained therein.

NOTICE!!

These documents have been scanned!

Do not place un-scanned documents beneath this notice!

Do not remove this notice from this file!

GPO Jacket No. 560-102
Print Order 61540
Rise Business Services, LLC
Job=AZ15 5/22/2019



Box Number= AZ15076



Claim Begin-End: AMC396287-AMC396292

4 Annual Filings



AZ15076-10

AMC396025-AMC396393

_____, 2018

United States Department of Interior
Bureau of Land Management
Records Section
One North Central Avenue
Suite 800
Phoenix, Arizona 85011

Notice of Intent
ANNUAL CLAIM MAINTENANCE FEES for 2018/2019,
By DESERT FOX SOMBRERO BUTTE CO

To Whom It May Concern:

The Final Rule as published in the Federal Register implements provisions of the Interior Department and related agencies, *that a Statutorily Authorized Adjustment effective June 30, 2014 that requires an annual rental fee of \$155.00* for each unpatented mining claim and site located and held under the General Mining Law of 1872.

This will serve as notice that **DESERT FOX SOMBRERO BUTTE CO**, whose address for purposes of this filing is 11280 North Shadow Vista Place Tucson, Arizona 85742 intends to hold the mining claims and /or mill sites described in **Exhibit "A"** attached hereto for the assessment years **2018/2019**, by payment of the annual claim maintenance fee of **\$155.00** per claim or site. Payment of **\$11,935.00** is made herewith for such assessment years for each of the unpatented lode claims and sites. The name, BLM serial number, book and page or index number of recording of the location notice is official records of Pinal County, Arizona, of which are set forth in **Exhibit "A"** attached hereto and by this reference incorporated herein.

Sincerely,

Daniel L Mead
Cornerstone Lands LLC
Agent for: DESERT FOX SOMBRERO BUTTE CO

Telephone 520-419-2622

Cc: file

371533
396287
371533 357560
396287 357853
420234 357871
357873
358745
358746
358032
359987
360058

PHOENIX, ARIZONA
2018 JUL 25 A 9:14

4219736

ENTERED
JUL 30 2018
BY: Ram

DESERT FOX SOMBRERO BUTTE CO

Notice of Intent to hold the foregoing unpatented Mining Claims for 2018/2019:

NO.	AMC	Claim Name	County	Book	Fee Number
1	371533	MAX F1	Pinal	2006	27209
2	371534	MAX F2	Pinal	2006	27210
3	371535	MAX F3	Pinal	2006	27211
4	371536	MAX F4	Pinal	2006	27212
5	371537	MAX F5	Pinal	2006	27213
6	371538	MAX 5	Pinal	2006	31771
7	371539	MAX 6	Pinal	2006	31772
8	371540	MAX 7	Pinal	2006	31773
9	371541	MAX 8	Pinal	2006	31774
10	371542	MAX 9	Pinal	2006	31775
11	371543	MAX 10	Pinal	2006	31776
12	371544	MAX 11	Pinal	2006	31777
13	371545	MAX 12	Pinal	2006	31778
14	371546	MAX 13	Pinal	2006	31779
15	371547	MAX 14	Pinal	2006	31780
16	371548	MAX 15	Pinal	2006	31781
17	371549	MAX 16	Pinal	2006	31782
18	371550	MAX 17	Pinal	2006	31783
19	371551	MAX 18	Pinal	2006	31784
20	371552	MAX 19	Pinal	2006	31785
21	371553	MAX 20	Pinal	2006	31786
22	371554	MAX 21	Pinal	2006	31787
23	371555	MAX 22	Pinal	2006	31788
24	371556	MAX 23	Pinal	2006	31789
25	371557	MAX 24	Pinal	2006	31790
26	371558	MAX 25	Pinal	2006	31791
27	371559	MAX 26	Pinal	2006	31792
28	371560	MAX 27	Pinal	2006	31793
29	371561	MAX 28	Pinal	2006	31794
30	371562	MAX 29	Pinal	2006	31795
31	371563	MAX 30	Pinal	2006	31796
32	371564	MAX 31	Pinal	2006	31797
33	396287	AMY 7	Pinal	2008	119817
34	396288	AMY 9	Pinal	2008	119819
35	396289	AMY 11	Pinal	2008	119821
36	396290	AMY 13	Pinal	2008	119823

37	396291	7	AMY 15	Pinal	2008	119825
38	396292	J	AMY 17	Pinal	2008	119827
39	357560	7	Magma Chief Ext.	Pinal	2003	20795
40	357561		Battle Axe	Pinal	2003	20796
41	357562	J	Kin Sabie	Pinal	2003	20794
42	357853	7	Sunset	Pinal	2003	26072
43	357854	J	Jewel	Pinal	2003	26073
44	357871	←	Hot Foot Johnny	Pinal	2003	27362
45	357873	7	Bagdad MS3601	Pinal	2003	29683
46	357874	J	Copper Reef No. 2	Pinal	2003	29682
47	358745	7	Copper Ridge	Pinal	2003	80487
48	358746	J	Copper Ridge 1	Pinal	2003	80488
49	358032	←	Lookout MS3601	Pinal	2003	53907
50	357875	←	Sunday	Pinal	2003	29684
51	359987	7	Sunset 1	Pinal	2004	10787
52	359988		Sunset 2	Pinal	2004	10788
53	359989	J	Sunset 3	Pinal	2004	10789
54	360058	←	Copper Triangle	Pinal	2004	67577
55	359990	←	Red Mountain	Pinal	2004	10786
56	420234	7	AMY 1	Pinal	2012	103555
57	420235		AMY 2	Pinal	2012	103556
58	420236		AMY 3	Pinal	2012	103557
59	420237		AMY 4	Pinal	2012	103558
60	420238		AMY 5	Pinal	2012	103559
61	420239		AMY 6	Pinal	2012	103560
62	420240		AMY 8	Pinal	2012	103561
63	420241		AMY 10	Pinal	2012	103562
64	420242		AMY 12	Pinal	2012	103563
65	420243		AMY 14	Pinal	2012	103564
66	420244		AMY 16	Pinal	2012	103565
67	420245		AMY 18	Pinal	2012	103566
68	420246		AMY 19	Pinal	2012	103567
69	420247		AMY 20	Pinal	2012	103568
70	420248		AMY 21	Pinal	2012	103569
71	420249		AMY 22	Pinal	2012	103570
72	420250		AMY 23	Pinal	2012	103571
73	420251		AMY 24	Pinal	2012	103572
74	420252		AMY 25	Pinal	2012	103573
75	420253		AMY 26	Pinal	2012	103574
76	420254		AMY 27	Pinal	2012	103575
77	420255	J	AMY 28	Pinal	2012	103576

Total number of unpatented mining claims = 77

United States Department of the Interior
Bureau of Land Management
 DIV OF LANDS, MINRLS & ENERGY
 ONE N CENTRAL AVE
 PHOENIX, AZ 85004 -4427
 Phone: 602-417-9200

Receipt

No: 4219736

Transaction #: 4334925	
Date of Transaction: 07/26/2018	
CUSTOMER:	
DESERT FOX SOMBRERO BUTTE CO 11280 N SHADOW VISTA PL ORO VALLEY, AZ 85742-9678 US	

LINE #	QTY	DESCRIPTION	REMARKS	UNIT PRICE	TOTAL
1	1.00	LOCATABLE MINERALS / MINING CLAIMS- NOT NEW-UNADJUD, ONE AUTH NO. ONLY / MINING CLAIM MONEY RECEIVED CASES: AMC371533/\$11935.00	MAINT 2019/77	- n/a -	11935.00
TOTAL:					\$11,935.00

PAYMENT INFORMATION			
1	AMOUNT:	11935.00	POSTMARKED: N/A
	TYPE:	CHECK	RECEIVED: 07/26/2018
	CHECK NO:	2085	
	NAME:	DESERT FOX SOMBRERO BUTTE CO STE 650 - 340 12 AVE SW CALGARY AB T2R 1L5 CA	

REMARKS

This receipt was generated by the automated BLM Collections and Billing System and is a paper representation of a portion of the official electronic record contained therein.

_____, 2018

United States Department of Interior
Bureau of Land Management
Records Section
One North Central Avenue
Suite 800
Phoenix, Arizona 85011

Notice of Intent
ANNUAL CLAIM MAINTENANCE FEES for 2018/2019,
By DESERT FOX SOMBRERO BUTTE CO

To Whom It May Concern:

The Final Rule as published in the Federal Register implements provisions of the Interior Department and related agencies, *that a Statutorily Authorized Adjustment effective June 30, 2014 that requires an annual rental fee of \$155.00* for each unpatented mining claim and site located and held under the General Mining Law of 1872.

This will serve as notice that **DESERT FOX SOMBRERO BUTTE CO**, whose address for purposes of this filing is 11280 North Shadow Vista Place Tucson, Arizona 85742 intends to hold the mining claims and /or mill sites described in **Exhibit "A"** attached hereto for the assessment years **2018/2019**, by payment of the annual claim maintenance fee of **\$155.00** per claim or site. Payment of **\$11,935.00** is made herewith for such assessment years for each of the unpatented lode claims and sites. The name, BLM serial number, book and page or index number of recording of the location notice is official records of Pinal County, Arizona, of which are set forth in **Exhibit "A"** attached hereto and by this reference incorporated herein.

Sincerely,

Daniel L Mead
Cornerstone Lands LLC
Agent for: DESERT FOX SOMBRERO BUTTE CO

Telephone 520-419-2622

Cc: file

	371533	357560
	396287	357853
	420234	357871
		357873
		358745
		358746
		358032
		359987
		360058

4219736

PHOENIX, ARIZONA
2018 JUL 25 A 9:14
ENTERED
JUL 30 2018
BY: Ram

DESERT FOX SOMBRERO BUTTE CO

Notice of Intent to hold the foregoing unpatented Mining Claims for 2018/2019:

NO.	AMC	Claim Name	County	Book	Fee Number
1	371533	7 MAX F1	Pinal	2006	27209
2	371534	MAX F2	Pinal	2006	27210
3	371535	MAX F3	Pinal	2006	27211
4	371536	MAX F4	Pinal	2006	27212
5	371537	MAX F5	Pinal	2006	27213
6	371538	MAX 5	Pinal	2006	31771
7	371539	MAX 6	Pinal	2006	31772
8	371540	MAX 7	Pinal	2006	31773
9	371541	MAX 8	Pinal	2006	31774
10	371542	MAX 9	Pinal	2006	31775
11	371543	MAX 10	Pinal	2006	31776
12	371544	MAX 11	Pinal	2006	31777
13	371545	MAX 12	Pinal	2006	31778
14	371546	MAX 13	Pinal	2006	31779
15	371547	MAX 14	Pinal	2006	31780
16	371548	MAX 15	Pinal	2006	31781
17	371549	MAX 16	Pinal	2006	31782
18	371550	MAX 17	Pinal	2006	31783
19	371551	MAX 18	Pinal	2006	31784
20	371552	MAX 19	Pinal	2006	31785
21	371553	MAX 20	Pinal	2006	31786
22	371554	MAX 21	Pinal	2006	31787
23	371555	MAX 22	Pinal	2006	31788
24	371556	MAX 23	Pinal	2006	31789
25	371557	MAX 24	Pinal	2006	31790
26	371558	MAX 25	Pinal	2006	31791
27	371559	MAX 26	Pinal	2006	31792
28	371560	MAX 27	Pinal	2006	31793
29	371561	MAX 28	Pinal	2006	31794
30	371562	MAX 29	Pinal	2006	31795
31	371563	MAX 30	Pinal	2006	31796
32	371564	MAX 31	Pinal	2006	31797
33	396287	7 AMY 7	Pinal	2008	119817
34	396288	AMY 9	Pinal	2008	119819
35	396289	AMY 11	Pinal	2008	119821
36	396290	AMY 13	Pinal	2008	119823

37	396291	7	AMY 15	Pinal	2008	119825
38	396292	J	AMY 17	Pinal	2008	119827
39	357560	7	Magma Chief Ext.	Pinal	2003	20795
40	357561		Battle Axe	Pinal	2003	20796
41	357562	J	Kin Sabie	Pinal	2003	20794
42	357853	J	Sunset	Pinal	2003	26072
43	357854	J	Jewel	Pinal	2003	26073
44	357871	←	Hot Foot Johnny	Pinal	2003	27362
45	357873	7	Bagdad MS3601	Pinal	2003	29683
46	357874	J	Copper Reef No. 2	Pinal	2003	29682
47	358745	7	Copper Ridge	Pinal	2003	80487
48	358746	J	Copper Ridge 1	Pinal	2003	80488
49	358032	←	Lookout MS3601	Pinal	2003	53907
50	357875	←	Sunday	Pinal	2003	29684
51	359987	7	Sunset 1	Pinal	2004	10787
52	359988		Sunset 2	Pinal	2004	10788
53	359989	J	Sunset 3	Pinal	2004	10789
54	360058	←	Copper Triangle	Pinal	2004	67577
55	359990	←	Red Mountain	Pinal	2004	10786
56	420234	7	AMY 1	Pinal	2012	103555
57	420235		AMY 2	Pinal	2012	103556
58	420236		AMY 3	Pinal	2012	103557
59	420237		AMY 4	Pinal	2012	103558
60	420238		AMY 5	Pinal	2012	103559
61	420239		AMY 6	Pinal	2012	103560
62	420240		AMY 8	Pinal	2012	103561
63	420241		AMY 10	Pinal	2012	103562
64	420242		AMY 12	Pinal	2012	103563
65	420243		AMY 14	Pinal	2012	103564
66	420244		AMY 16	Pinal	2012	103565
67	420245		AMY 18	Pinal	2012	103566
68	420246		AMY 19	Pinal	2012	103567
69	420247		AMY 20	Pinal	2012	103568
70	420248		AMY 21	Pinal	2012	103569
71	420249		AMY 22	Pinal	2012	103570
72	420250		AMY 23	Pinal	2012	103571
73	420251		AMY 24	Pinal	2012	103572
74	420252		AMY 25	Pinal	2012	103573
75	420253		AMY 26	Pinal	2012	103574
76	420254		AMY 27	Pinal	2012	103575
77	420255	J	AMY 28	Pinal	2012	103576

Total number of unpatented mining claims = 77

United States Department of the Interior
Bureau of Land Management
 DIV OF LANDS, MINRLS & ENERGY
 ONE N CENTRAL AVE
 PHOENIX, AZ 85004 -4427
 Phone: 602-417-9200

Receipt

No: 4219736

Transaction #: 4334925	
Date of Transaction: 07/26/2018	
CUSTOMER:	
DESERT FOX SOMBRERO BUTTE CO 11280 N SHADOW VISTA PL ORO VALLEY, AZ 85742-9678 US	

LINE #	QTY	DESCRIPTION	REMARKS	UNIT PRICE	TOTAL
1	1.00	LOCATABLE MINERALS / MINING CLAIMS- NOT NEW-UNADJUD, ONE AUTH NO. ONLY / MINING CLAIM MONEY RECEIVED CASES: AMC371533/\$11935.00	MAINT 2019/77	- n/a -	11935.00
TOTAL:					\$11,935.00

PAYMENT INFORMATION			
1	AMOUNT:	11935.00	POSTMARKED: N/A
	TYPE:	CHECK	RECEIVED: 07/26/2018
	CHECK NO:	2085	
	NAME:	DESERT FOX SOMBRERO BUTTE CO STE 650 - 340 12 AVE SW CALGARY AB T2R 1L5 CA	

REMARKS

This receipt was generated by the automated BLM Collections and Billing System and is a paper representation of a portion of the official electronic record contained therein.

371533

357873

396287

8-1 - , 2017

420234

357560

United States Department of Interior
Bureau of Land Management
Records Section
One North Central Avenue
Suite 800
Phoenix, Arizona 85011

357853

358032

358746

Notice of Intent

ANNUAL CLAIM MAINTENANCE FEES for 2017/2018,
By DESERT FOX SOMBRERO BUTTE CO

357871

359987

To Whom It May Concern:

360058

The Final Rule as published in the Federal Register implements provisions of the Interior Department and related agencies, *that a Statutorily Authorized Adjustment effective June 30, 2014 that requires an annual rental fee of \$155.00* for each unpatented mining claim and site located and held under the General Mining Law of 1872.

This will serve as notice that **DESERT FOX SOMBRERO BUTTE CO**, whose address for purposes of this filing is 11280 North Shadow Vista Place Tucson, Arizona 85742 intends to hold the mining claims and /or mill sites described in **Exhibit "A"** attached hereto for the assessment years **2017/2018**, by payment of the annual claim maintenance fee of **\$155.00** per claim or site. Payment of **\$11,935.00** is made herewith for such assessment years for each of the unpatented lode claims and sites. The name, BLM serial number, book and page or index number of recording of the location notice is official records of Pinal County, Arizona, of which are set forth in **Exhibit "A"** attached hereto and by this reference incorporated herein.

Sincerely,

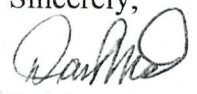

Daniel L Mead
Cornerstone Lands LLC
Agent for: DESERT FOX SOMBRERO BUTTE CO

Telephone 520-419-2622

Cc: file

RECEIVED
PHOENIX, ARIZONA
2017 AUG 23 A 10:43
OFFICE

ENTERED
AUG 25 2017
BY: RAM

DESERT FOX SOMBRERO BUTTE CO

Notice of Intent to hold the foregoing unpatented Mining Claims for 2017/2018:

NO.	AMC	Claim Name	County	Book	Fee Number
1	371533	7 MAX F1	Pinal	2006	27209
2	371534	MAX F2	Pinal	2006	27210
3	371535	MAX F3	Pinal	2006	27211
4	371536	MAX F4	Pinal	2006	27212
5	371537	MAX F5	Pinal	2006	27213
6	371538	MAX 5	Pinal	2006	31771
7	371539	MAX 6	Pinal	2006	31772
8	371540	MAX 7	Pinal	2006	31773
9	371541	MAX 8	Pinal	2006	31774
10	371542	MAX 9	Pinal	2006	31775
11	371543	MAX 10	Pinal	2006	31776
12	371544	MAX 11	Pinal	2006	31777
13	371545	MAX 12	Pinal	2006	31778
14	371546	MAX 13	Pinal	2006	31779
15	371547	MAX 14	Pinal	2006	31780
16	371548	MAX 15	Pinal	2006	31781
17	371549	MAX 16	Pinal	2006	31782
18	371550	MAX 17	Pinal	2006	31783
19	371551	MAX 18	Pinal	2006	31784
20	371552	MAX 19	Pinal	2006	31785
21	371553	MAX 20	Pinal	2006	31786
22	371554	MAX 21	Pinal	2006	31787
23	371555	MAX 22	Pinal	2006	31788
24	371556	MAX 23	Pinal	2006	31789
25	371557	MAX 24	Pinal	2006	31790
26	371558	MAX 25	Pinal	2006	31791
27	371559	MAX 26	Pinal	2006	31792
28	371560	MAX 27	Pinal	2006	31793
29	371561	MAX 28	Pinal	2006	31794
30	371562	MAX 29	Pinal	2006	31795
31	371563	MAX 30	Pinal	2006	31796
32	371564	✓ MAX 31	Pinal	2006	31797
33	396287	7 AMY 7	Pinal	2008	119817
34	396288	AMY 9	Pinal	2008	119819
35	396289	✓ AMY 11	Pinal	2008	119821
36	396290	✓ AMY 13	Pinal	2008	119823

RECEIVED
 MAY 23 10:43
 STATE OFFICE

AR04 PAID

37	396291	AMY 15	Pinal	2008	119825
38	396292	AMY 17	Pinal	2008	119827
39	357560	Magma Chief Ext.	Pinal	2003	20795
40	357561	Battle Axe	Pinal	2003	20796
41	357562	Kin Sabie	Pinal	2003	20794
42	357853	Sunset	Pinal	2003	26072
43	357854	Jewel	Pinal	2003	26073
44	357871	Hot Foot Johny	Pinal	2003	27362
45	357873	Bagdad MS3601	Pinal	2003	29683
46	357874	Copper Reef No. 2	Pinal	2003	29682
47	358745	Copper Ridge	Pinal	2003	80487
48	358746	Copper Ridge 1	Pinal	2003	80488
49	358032	Lookout MS3601	Pinal	2003	53907
50	357875	Sunday	Pinal	2003	29684
51	359987	Sunset 1	Pinal	2004	10787
52	359988	Sunset 2	Pinal	2004	10788
53	359989	Sunset 3	Pinal	2004	10789
54	360058	Copper Triangle	Pinal	2004	67577
55	359990	Red Mountain	Pinal	2004	10786
56	420234	AMY 1	Pinal	2012	103555
57	420235	AMY 2	Pinal	2012	103556
58	420236	AMY 3	Pinal	2012	103557
59	420237	AMY 4	Pinal	2012	103558
60	420238	AMY 5	Pinal	2012	103559
61	420239	AMY 6	Pinal	2012	103560
62	420240	AMY 8	Pinal	2012	103561
63	420241	AMY 10	Pinal	2012	103562
64	420242	AMY 12	Pinal	2012	103563
65	420243	AMY 14	Pinal	2012	103564
66	420244	AMY 16	Pinal	2012	103565
67	420245	AMY 18	Pinal	2012	103566
68	420246	AMY 19	Pinal	2012	103567
69	420247	AMY 20	Pinal	2012	103568
70	420248	AMY 21	Pinal	2012	103569
71	420249	AMY 22	Pinal	2012	103570
72	420250	AMY 23	Pinal	2012	103571
73	420251	AMY 24	Pinal	2012	103572
74	420252	AMY 25	Pinal	2012	103573
75	420253	AMY 26	Pinal	2012	103574
76	420254	AMY 27	Pinal	2012	103575
77	420255	AMY 28	Pinal	2012	103576

RECEIVED
MAY 23 2011
A 10 43
OFFICE

Total number of unpatented mining claims = 77

NO. OF CLAIMS 77
 AMOUNT 11935.00
 RECEIPT NO. _____
 UNIT. PER
 ** BLM-ASO**

United States Department of the Interior
Bureau of Land Management
 DIV OF LANDS, MINRLS & ENERGY
 ONE N CENTRAL AVE
 PHOENIX, AZ 85004 -4427
 Phone: 602-417-9200

Receipt

No: 3952001

Transaction #: 4061732	
Date of Transaction: 08/23/2017	
CUSTOMER:	
DESERT FOX SOMBRERO BUTTE CO 11280 N SHADOW VISTA PL ORO VALLEY, AZ 85742-9678 US	

LINE #	QTY	DESCRIPTION	REMARKS	UNIT PRICE	TOTAL
1	1.00	LOCATABLE MINERALS / MINING CLAIMS- NOT NEW-UNADJUD, ONE AUTH MINING CLAIM MONEY RECEIV CASES: AMC371533/\$11935.00	USE MONEY FROM OWNER OF CLAIM.	- n/a -	11935.00
TOTAL:					\$11,935.00

PAYMENT ID		AMOUNT:	TYPE:	CHECK NO:	NAME:	RECORDED:	RECEIVED:
1		11935.00	CHECK	2083	DESERT FOX SOMBRERO BUTTE CO 11280 N SHADOW VISTA PL ORO VALLEY AZ 85742-9678 US	N/A	08/23/2017

REMARKS

This receipt was generated by the automated BLM Collections and Billing System and is a paper representation of a portion of the official electronic record contained therein.

United States Department of the Interior
Bureau of Land Management
 BUSINESS & SUPPORT SVCS DIV
 ONE N CENTRAL AVE SUITE 800
 PHOENIX, AZ 85004 -4427
 Phone: 602-417-9200

Receipt



No: 3945925

Transaction #: 4055626	
Date of Transaction: 08/20/2017	
CUSTOMER:	
F N HAWKINS 2222 W CLEARVIEW TRAIL ANTHEM, AZ 85086 US	

LINE #	QTY	DESCRIPTION	REMARKS	UNIT PRICE	TOTAL
1	1.00	LOCATABLE MINERALS / MINING CLAIMS- NOT NEW-UNADJUD, ONE AUTH NO. ONLY / MINING CLAIM MONEY RECEIVED CASES: AMC357561/\$155.00		- n/a -	155.00
TOTAL:					\$155.00

PAYMENT INFORMATION			
NOTE: Items will appear on credit card statement as "BLM O Mining Claim".			
1	AMOUNT:	155.00	POSTMARKED: N/A
	TYPE:	CREDIT CARD	RECEIVED: 08/20/2017
	NAME:	F N HAWKINS 2222 W CLEARVIEW TRAIL ANTHEM AZ 85086 US	
	CARD NO:	XXXXXXXXXXXX0411	AUTH CODE: 02017P
	NAME ON CARD:	F N HAWKINS	
	EXPIRES:	05/2020	
	SIGNATURE:		

REMARKS

This receipt was generated by the automated BLM Collections and Billing System and is a paper representation of a portion of the official electronic record contained therein.

AMC 357561 Battle Ax Payment Portal

*10/2/2017 REFUND PROCESSED
FOR MULTIPLE PAYMENT
ON AMC357561. AM*

371533
396287
357560
357853
357871
357873
358745
358746
358032
359987
360058

420234

7-16, 2016

United States Department of Interior
Bureau of Land Management
Records Section
One North Central Avenue
Suite 800
Phoenix, Arizona 85011

Notice of Intent
ANNUAL CLAIM MAINTENANCE FEES for 2016/2017,
By DESERT FOX SOMBRERO BUTTE CO

To Whom It May Concern:

The Final Rule as published in the Federal Register implements provisions of the Interior Department and related agencies, *that a Statutorily Authorized Adjustment effective June 30, 2014 that requires an annual rental fee of \$155.00* for each unpatented mining claim and site located and held under the General Mining Law of 1872.

This will serve as notice that **DESERT FOX SOMBRERO BUTTE CO**, whose address for purposes of this filing is 11280 North Shadow Vista Place Tucson, Arizona 85742 intends to hold the mining claims and /or mill sites described in **Exhibit "A"** attached hereto for the assessment years **2016/2017**, by payment of the annual claim maintenance fee of **\$155.00** per claim or site. Payment of **\$11,935.00** is made herewith for such assessment years for each of the unpatented lode claims and sites. The name, BLM serial number, book and page or index number of recording of the location notice is official records of Pinal County, Arizona, of which are set forth in **Exhibit "A"** attached hereto and by this reference incorporated herein.

Sincerely,

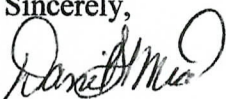

Daniel L Mead
Cornerstone Lands LLC
Agent for: DESERT FOX SOMBRERO BUTTE CO

Telephone 520-419-2622

Cc: file

RECEIVED
BLM AZ STATE OFFICE
2016 JUL 20 A 9:45
PHOENIX, ARIZONA

3610238

ENTERED
JUL 21 2016
BY: RAM

DESERT FOX SOMBRERO BUTTE CO

Notice of Intent to hold the foregoing unpatented Mining Claims for 2016/2017:

NO.	AMC	Claim Name	County	Book	Fee Number
1	371533	MAX F1	Pinal	2006	27209
2	371534	MAX F2	Pinal	2006	27210
3	371535	MAX F3	Pinal	2006	27211
4	371536	MAX F4	Pinal	2006	27212
5	371537	MAX F5	Pinal	2006	27213
6	371538	MAX 5	Pinal	2006	31771
7	371539	MAX 6	Pinal	2006	31772
8	371540	MAX 7	Pinal	2006	31773
9	371541	MAX 8	Pinal	2006	31774
10	371542	MAX 9	Pinal	2006	31775
11	371543	MAX 10	Pinal	2006	31776
12	371544	MAX 11	Pinal	2006	31777
13	371545	MAX 12	Pinal	2006	31778
14	371546	MAX 13	Pinal	2006	31779
15	371547	MAX 14	Pinal	2006	31780
16	371548	MAX 15	Pinal	2006	31781
17	371549	MAX 16	Pinal	2006	31782
18	371550	MAX 17	Pinal	2006	31783
19	371551	MAX 18	Pinal	2006	31784
20	371552	MAX 19	Pinal	2006	31785
21	371553	MAX 20	Pinal	2006	31786
22	371554	MAX 21	Pinal	2006	31787
23	371555	MAX 22	Pinal	2006	31788
24	371556	MAX 23	Pinal	2006	31789
25	371557	MAX 24	Pinal	2006	31790
26	371558	MAX 25	Pinal	2006	31791
27	371559	MAX 26	Pinal	2006	31792
28	371560	MAX 27	Pinal	2006	31793
29	371561	MAX 28	Pinal	2006	31794
30	371562	MAX 29	Pinal	2006	31795
31	371563	MAX 30	Pinal	2006	31796
32	371564	MAX 31	Pinal	2006	31797
33	396287	AMY 7	Pinal	2008	119817
34	396288	AMY 9	Pinal	2008	119819
35	396289	AMY 11	Pinal	2008	119821
36	396290	AMY 13	Pinal	2008	119823

RECEIVED
 MIN. AZ. STATE OFFICE
 2016 JUL 20 A 9:45

RECEIVED
JULIA STATE OFFICE

2016 JUL 20 A 9:46

MOBENIX, ARIZONA

37	396291	AMY 15	Pinal	2008	119825
38	396292	AMY 17	Pinal	2008	119827
39	357560	Magma Chief Ext.	Pinal	2003	20795
40	357561	Battle Axe	Pinal	2003	20796
41	357562	Kin Sabie	Pinal	2003	20794
42	357853	Sunset	Pinal	2003	26072
43	357854	Jewel	Pinal	2003	26073
44	357871	Hot Foot Johny	Pinal	2003	27362
45	357873	Bagdad MS3601	Pinal	2003	29683
46	357874	Copper Reef No. 2	Pinal	2003	29682
47	358745	Copper Ridge	Pinal	2003	80487
48	358746	Copper Ridge 1	Pinal	2003	80488
49	358032	Lookout MS3601	Pinal	2003	53907
50	357875	Sunday	Pinal	2003	29684
51	359987	Sunset 1	Pinal	2004	10787
52	359988	Sunset 2	Pinal	2004	10788
53	359989	Sunset 3	Pinal	2004	10789
54	360058	Copper Triangle	Pinal	2004	67577
55	359990	Red Mountain	Pinal	2004	10786
56	420234	AMY 1	Pinal	2012	103555
57	420235	AMY 2	Pinal	2012	103556
58	420236	AMY 3	Pinal	2012	103557
59	420237	AMY 4	Pinal	2012	103558
60	420238	AMY 5	Pinal	2012	103559
61	420239	AMY 6	Pinal	2012	103560
62	420240	AMY 8	Pinal	2012	103561
63	420241	AMY 10	Pinal	2012	103562
64	420242	AMY 12	Pinal	2012	103563
65	420243	AMY 14	Pinal	2012	103564
66	420244	AMY 16	Pinal	2012	103565
67	420245	AMY 18	Pinal	2012	103566
68	420246	AMY 19	Pinal	2012	103567
69	420247	AMY 20	Pinal	2012	103568
70	420248	AMY 21	Pinal	2012	103569
71	420249	AMY 22	Pinal	2012	103570
72	420250	AMY 23	Pinal	2012	103571
73	420251	AMY 24	Pinal	2012	103572
74	420252	AMY 25	Pinal	2012	103573
75	420253	AMY 26	Pinal	2012	103574
76	420254	AMY 27	Pinal	2012	103575
77	420255	AMY 28	Pinal	2012	103576

Total number of unpatented mining claims = 77

RECEIVED
 MINERAL STATE OFFICE
 JUL 20 9 45 AM '12

RECEIVED
BLN AZ STATE OFFICE

2016 JUL 20 A 9:46

PHOENIX, ARIZONA

**United States Department of the Interior
Bureau of Land Management
DIV OF LANDS, MINRLS & ENERGY
ONE N CENTRAL AVE
PHOENIX, AZ 85004 -4427
Phone: 602-417-9200**

Receipt

No: 3610238

Transaction #: 3713750	
Date of Transaction: 07/20/2016	
CUSTOMER:	
DESERT FOX SOMBRERO BUTTE CO 11280 N SHADOW VISTA PL ORO VALLEY, AZ 85742-9678 US	

LINE #	QTY	DESCRIPTION	REMARKS	UNIT PRICE	TOTAL
1	1.00	LOCATABLE MINERALS / MINING CLAIMS- NOT NEW-UNADJUD, ONE AUTH NO. ONLY / MINING CLAIM MONEY RECEIVED CASES: AMC371533/\$11935.00	MAINT 2017/77	- n/a -	11935.00
TOTAL:					\$11,935.00

PAYMENT INFORMATION			
1	AMOUNT:	11935.00	POSTMARKED: N/A
	TYPE:	CHECK	RECEIVED: 07/20/2016
	CHECK NO:	3176	
	NAME:	DESERT FOX VAN DYKE CO STE 650-340 12 AVE SW CALGARY AB CANADA NS T2R 1L5	

REMARKS

This receipt was generated by the automated BLM Collections and Billing System and is a paper representation of a portion of the official electronic record contained therein.

7-16, 2016

United States Department of Interior
Bureau of Land Management
Records Section
One North Central Avenue
Suite 800
Phoenix, Arizona 85011

Notice of Intent
ANNUAL CLAIM MAINTENANCE FEES for 2016/2017,
By DESERT FOX SOMBRERO BUTTE CO

To Whom It May Concern:

The Final Rule as published in the Federal Register implements provisions of the Interior Department and related agencies, *that a Statutorily Authorized Adjustment effective June 30, 2014 that requires an annual rental fee of \$155.00* for each unpatented mining claim and site located and held under the General Mining Law of 1872.

This will serve as notice that **DESERT FOX SOMBRERO BUTTE CO**, whose address for purposes of this filing is 11280 North Shadow Vista Place Tucson, Arizona 85742 intends to hold the mining claims and /or mill sites described in **Exhibit "A"** attached hereto for the assessment years **2016/2017**, by payment of the annual claim maintenance fee of **\$155.00** per claim or site. Payment of **\$11,935.00** is made herewith for such assessment years for each of the unpatented lode claims and sites. The name, BLM serial number, book and page or index number of recording of the location notice is official records of Pinal County, Arizona, of which are set forth in **Exhibit "A"** attached hereto and by this reference incorporated herein.

Sincerely,



Daniel L Mead
Cornerstone Lands LLC
Agent for: DESERT FOX SOMBRERO BUTTE CO

Telephone 520-419-2622

Cc: file

RECEIVED
BLM AZ STATE OFFICE
2016 JUL 20 A 9:45
PHOENIX, ARIZONA

3610238

INTERED
JUL 21 2016
BY: Ran

DESERT FOX SOMBRERO BUTTE CO

Notice of Intent to hold the foregoing unpatented Mining Claims for 2016/2017:

NO.	AMC	Claim Name	County	Book	Fee Number
1	371533	MAX F1	Pinal	2006	27209
2	371534	MAX F2	Pinal	2006	27210
3	371535	MAX F3	Pinal	2006	27211
4	371536	MAX F4	Pinal	2006	27212
5	371537	MAX F5	Pinal	2006	27213
6	371538	MAX 5	Pinal	2006	31771
7	371539	MAX 6	Pinal	2006	31772
8	371540	MAX 7	Pinal	2006	31773
9	371541	MAX 8	Pinal	2006	31774
10	371542	MAX 9	Pinal	2006	31775
11	371543	MAX 10	Pinal	2006	31776
12	371544	MAX 11	Pinal	2006	31777
13	371545	MAX 12	Pinal	2006	31778
14	371546	MAX 13	Pinal	2006	31779
15	371547	MAX 14	Pinal	2006	31780
16	371548	MAX 15	Pinal	2006	31781
17	371549	MAX 16	Pinal	2006	31782
18	371550	MAX 17	Pinal	2006	31783
19	371551	MAX 18	Pinal	2006	31784
20	371552	MAX 19	Pinal	2006	31785
21	371553	MAX 20	Pinal	2006	31786
22	371554	MAX 21	Pinal	2006	31787
23	371555	MAX 22	Pinal	2006	31788
24	371556	MAX 23	Pinal	2006	31789
25	371557	MAX 24	Pinal	2006	31790
26	371558	MAX 25	Pinal	2006	31791
27	371559	MAX 26	Pinal	2006	31792
28	371560	MAX 27	Pinal	2006	31793
29	371561	MAX 28	Pinal	2006	31794
30	371562	MAX 29	Pinal	2006	31795
31	371563	MAX 30	Pinal	2006	31796
32	371564	MAX 31	Pinal	2006	31797
33	396287	AMY 7	Pinal	2008	119817
34	396288	AMY 9	Pinal	2008	119819
35	396289	AMY 11	Pinal	2008	119821
36	396290	AMY 13	Pinal	2008	119823

RECEIVED
 U.S. STATE OFFICE
 JUL 20 A 9:45

r

L

r

L

37	396291	AMY 15	Pinal	2008	119825
38	396292	AMY 17	Pinal	2008	119827
39	357560	Magma Chief Ext.	Pinal	2003	20795
40	357561	Battle Axe	Pinal	2003	20796
41	357562	Kin Sabie	Pinal	2003	20794
42	357853	Sunset	Pinal	2003	26072
43	357854	Jewel	Pinal	2003	26073
44	357871	Hot Foot Johny	Pinal	2003	27362
45	357873	Bagdad MS3601	Pinal	2003	29683
46	357874	Copper Reef No. 2	Pinal	2003	29682
47	358745	Copper Ridge	Pinal	2003	80487
48	358746	Copper Ridge 1	Pinal	2003	80488
49	358032	Lookout MS3601	Pinal	2003	53907
50	357875	Sunday	Pinal	2003	29684
51	359987	Sunset 1	Pinal	2004	10787
52	359988	Sunset 2	Pinal	2004	10788
53	359989	Sunset 3	Pinal	2004	10789
54	360058	Copper Triangle	Pinal	2004	67577
55	359990	Red Mountain	Pinal	2004	10786
56	420234	AMY 1	Pinal	2012	103555
57	420235	AMY 2	Pinal	2012	103556
58	420236	AMY 3	Pinal	2012	103557
59	420237	AMY 4	Pinal	2012	103558
60	420238	AMY 5	Pinal	2012	103559
61	420239	AMY 6	Pinal	2012	103560
62	420240	AMY 8	Pinal	2012	103561
63	420241	AMY 10	Pinal	2012	103562
64	420242	AMY 12	Pinal	2012	103563
65	420243	AMY 14	Pinal	2012	103564
66	420244	AMY 16	Pinal	2012	103565
67	420245	AMY 18	Pinal	2012	103566
68	420246	AMY 19	Pinal	2012	103567
69	420247	AMY 20	Pinal	2012	103568
70	420248	AMY 21	Pinal	2012	103569
71	420249	AMY 22	Pinal	2012	103570
72	420250	AMY 23	Pinal	2012	103571
73	420251	AMY 24	Pinal	2012	103572
74	420252	AMY 25	Pinal	2012	103573
75	420253	AMY 26	Pinal	2012	103574
76	420254	AMY 27	Pinal	2012	103575
77	420255	AMY 28	Pinal	2012	103576

Total number of unpatented mining claims = 77

2016 JUL 20 A 9:45
 HAZ STATE OFFICE
 PROPERTY

United States Department of the Interior
Bureau of Land Management
 DIV OF LANDS, MINRLS & ENERGY
 ONE N CENTRAL AVE
 PHOENIX, AZ 85004 -4427
 Phone: 602-417-9200

Receipt

No: 3610238

Transaction #: 3713750	
Date of Transaction: 07/20/2016	
CUSTOMER:	
DESERT FOX SOMBRERO BUTTE CO 11280 N SHADOW VISTA PL ORO VALLEY, AZ 85742-9678 US	

LINE #	QTY	DESCRIPTION	REMARKS	UNIT PRICE	TOTAL
1	1.00	LOCATABLE MINERALS / MINING CLAIMS- NOT NEW-UNADJUD, ONE AUTH NO. ONLY / MINING CLAIM MONEY RECEIVED CASES: AMC371533/\$11935.00	MAINT 2017/77	- n/a -	11935.00
TOTAL:					\$11,935.00

PAYMENT INFORMATION			
1	AMOUNT:	11935.00	POSTMARKED: N/A
	TYPE:	CHECK	RECEIVED: 07/20/2016
	CHECK NO:	3176	
	NAME:	DESERT FOX VAN DYKE CO STE 650-340 12 AVE SW CALGARY AB CANADA NS T2R 1L5	

REMARKS

This receipt was generated by the automated BLM Collections and Billing System and is a paper representation of a portion of the official electronic record contained therein.

July 15, 2015

United States Department of Interior
Bureau of Land Management
Records Section
One North Central Avenue
Suite 800
Phoenix, Arizona 85011

Notice of Intent
ANNUAL CLAIM MAINTENANCE FEES for 2015/2016,
By COPPER FOX SOMBRERO BUTTE CO

To Whom It May Concern:

The Final Rule as published in the Federal Register implements provisions of the Interior Department and related agencies, *that a Statutorily Authorized Adjustment effective June 30, 2014 that requires an annual rental fee of \$155.00* for each unpatented mining claim and site located and held under the General Mining Law of 1872.

This will serve as notice that **COPPER FOX SOMBRERO BUTTE CO**, whose address for purposes of this filing is 11280 North Shadow Vista Place Tucson, Arizona 85742 intends to hold the mining claims and /or mill sites described in **Exhibit "A"** attached hereto for the assessment years **2015/2016**, by payment of the annual claim maintenance fee of **\$155.00** per claim or site. Payment of **\$11,935.00** is made herewith for such assessment years for each of the unpatented lode claims and sites. The name, BLM serial number, book and page or index number of recording of the location notice is official records of Pinal County, Arizona, of which are set forth in **Exhibit "A"** attached hereto and by this reference incorporated herein.

Sincerely,

Daniel L Mead
Cornerstone Lands LLC
Agent for: COPPER FOX SOMBRERO BUTTE CO

Telephone 520-419-2622

Cc: file

~~920234~~ 371533
396287
420234 357560
357853
357871
357873
358745
358746
358032
357873
359987
360058

RECEIVED
BLM AZ STATE OFFICE
2015 JUL 24 A 9:01
PHOENIX, ARIZONA

3349696

ENTERED
JUL 27 2015
BY: R. Ann

COPPER FOX SOMBRERO BUTTE CO

Notice of Intent to hold the foregoing unpatented Mining Claims for 2015/2016:

NO.	AMC	Claim Name	County	Book	Fee Number
1	371533	MAX F1	Pinal	2006	27209
2	371534	MAX F2	Pinal	2006	27210
3	371535	MAX F3	Pinal	2006	27211
4	371536	MAX F4	Pinal	2006	27212
5	371537	MAX F5	Pinal	2006	27213
6	371538	MAX 5	Pinal	2006	31771
7	371539	MAX 6	Pinal	2006	31772
8	371540	MAX 7	Pinal	2006	31773
9	371541	MAX 8	Pinal	2006	31774
10	371542	MAX 9	Pinal	2006	31775
11	371543	MAX 10	Pinal	2006	31776
12	371544	MAX 11	Pinal	2006	31777
13	371545	MAX 12	Pinal	2006	31778
14	371546	MAX 13	Pinal	2006	31779
15	371547	MAX 14	Pinal	2006	31780
16	371548	MAX 15	Pinal	2006	31781
17	371549	MAX 16	Pinal	2006	31782
18	371550	MAX 17	Pinal	2006	31783
19	371551	MAX 18	Pinal	2006	31784
20	371552	MAX 19	Pinal	2006	31785
21	371553	MAX 20	Pinal	2006	31786
22	371554	MAX 21	Pinal	2006	31787
23	371555	MAX 22	Pinal	2006	31788
24	371556	MAX 23	Pinal	2006	31789
25	371557	MAX 24	Pinal	2006	31790
26	371558	MAX 25	Pinal	2006	31791
27	371559	MAX 26	Pinal	2006	31792
28	371560	MAX 27	Pinal	2006	31793
29	371561	MAX 28	Pinal	2006	31794
30	371562	MAX 29	Pinal	2006	31795
31	371563	MAX 30	Pinal	2006	31796
32	371564	MAX 31	Pinal	2006	31797
33	396287	AMY 7	Pinal	2008	119817
34	396288	AMY 9	Pinal	2008	119819
35	396289	AMY 11	Pinal	2008	119821
36	396290	AMY 13	Pinal	2008	119823

RECEIVED
 BLM AZ STATE OFFICE
 2015 JUL 24 A 9:02

37	396291	AMY 15	Pinal	2008	119825
38	396292	AMY 17	Pinal	2008	119827
39	357560	Magma Chief Ext.	Pinal	2003	20795
40	357561	Battle Axe	Pinal	2003	20796
41	357562	Kin Sabie	Pinal	2003	20794
42	357853	Sunset	Pinal	2003	26072
43	357854	Jewel	Pinal	2003	26073
44	357871	Hot Foot Johnny	Pinal	2003	27362
45	357873	Bagdad MS3601	Pinal	2003	29683
46	357874	Copper Reef No. 2	Pinal	2003	29682
47	358745	Copper Ridge	Pinal	2003	80487
48	358746	Copper Ridge 1	Pinal	2003	80488
49	358032	Lookout MS3601	Pinal	2003	53907
50	357875	Sunday	Pinal	2003	29684
51	359987	Sunset 1	Pinal	2004	10787
52	359988	Sunset 2	Pinal	2004	10788
53	359989	Sunset 3	Pinal	2004	10789
54	360058	Copper Triangle	Pinal	2004	67577
55	359990	Red Mountain	Pinal	2004	10786
56	420234	AMY 1	Pinal	2012	103555
57	420235	AMY 2	Pinal	2012	103556
58	420236	AMY 3	Pinal	2012	103557
59	420237	AMY 4	Pinal	2012	103558
60	420238	AMY 5	Pinal	2012	103559
61	420239	AMY 6	Pinal	2012	103560
62	420240	AMY 8	Pinal	2012	103561
63	420241	AMY 10	Pinal	2012	103562
64	420242	AMY 12	Pinal	2012	103563
65	420243	AMY 14	Pinal	2012	103564
66	420244	AMY 16	Pinal	2012	103565
67	420245	AMY 18	Pinal	2012	103566
68	420246	AMY 19	Pinal	2012	103567
69	420247	AMY 20	Pinal	2012	103568
70	420248	AMY 21	Pinal	2012	103569
71	420249	AMY 22	Pinal	2012	103570
72	420250	AMY 23	Pinal	2012	103571
73	420251	AMY 24	Pinal	2012	103572
74	420252	AMY 25	Pinal	2012	103573
75	420253	AMY 26	Pinal	2012	103574
76	420254	AMY 27	Pinal	2012	103575
77	420255	AMY 28	Pinal	2012	103576

Handwritten vertical marks on the left margin, consisting of several L-shaped and hook-like symbols.

RECEIVED
BLM AZ STATE OFFICE
2019 JUL 24 A 9:02

Total number of unpatented mining claims = 77

United States Department of the Interior
Bureau of Land Management
 LANDS/RECREATION & PLANNING
 ONE N CENTRAL AVE
 PHOENIX, AZ 85004 -2203
 Phone: 602-417-9200

Receipt

No: 3349696

Transaction #: 3447518	
Date of Transaction: 07/24/2015	
CUSTOMER:	
COPPER FOX SOMBRERO CO 11280 N SHADOW VISTA PL ORO VALLEY, AZ 85742-9678 US	

LINE #	QTY	DESCRIPTION	REMARKS	UNIT PRICE	TOTAL
1	1.00	LOCATABLE MINERALS / MINING CLAIMS- NOT NEW-UNADJUD, ONE AUTH NO. ONLY / MINING CLAIM MONEY RECEIVED CASES: AMC371533/\$11935.00	MAINT 2016/77	- n/a -	11935.00
TOTAL:					\$11,935.00

PAYMENT INFORMATION			
1	AMOUNT:	11935.00	POSTMARKED: N/A
	TYPE:	CHECK	RECEIVED: 07/24/2015
	CHECK NO:	2055	
	NAME:	DESERT COPPER FOX SOMBRERO CO STE 650 340 12 AVE SW CALGARY AB CANADA NS T2R 1L5	

REMARKS

This receipt was generated by the automated BLM Collections and Billing System and is a paper representation of a portion of the official electronic record contained therein.



 INTERED
 JUL 27 2015
 BY: *R.Am*

AMC 371533
396287
357560
357853
357871
357873
358745
358746
358032
359987
360058
420234

7-16, 2014

United States Department of Interior
Bureau of Land Management
Records Section
One North Central Avenue
Suite 800
Phoenix, Arizona 85011

NO. OF CLAIMS 77
AMOUNT 11935
RECEIPT NO. 3078185
INIT: SC
BLM-ASO

Notice of Intent
ANNUAL CLAIM MAINTENANCE FEES for 2014/2015,
By COPPER FOX SOMBRERO BUTTE CO

To Whom It May Concern:

The Final Rule as published in the Federal Register implements provisions of the Interior Department and related agencies, *that a Statutorily Authorized Adjustment effective June 30, 2014 that requires an annual rental fee of \$155.00* for each unpatented mining claim and site located and held under the General Mining Law of 1872.

This will serve as notice that **COPPER FOX SOMBRERO BUTTE CO**, whose address for purposes of this filing is 11280 North Shadow Vista Place Tucson, Arizona 85742 intends to hold the mining claims and /or mill sites described in **Exhibit "A"** attached hereto for the assessment years **2014/2015**, by payment of the annual claim maintenance fee of **\$155.00** per claim or site. Payment of **\$11,935.00** is made herewith for such assessment years for each of the unpatented lode claims and sites. The name, BLM serial number, book and page or index number of recording of the location notice is official records of Pinal County, Arizona, of which are set forth in **Exhibit "A"** attached hereto and by this reference incorporated herein.

Sincerely,

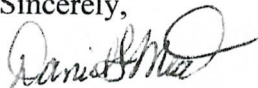

Daniel L Mead
Cornerstone Lands LLC
Agent for: COPPER FOX SOMBRERO BUTTE CO

Telephone 520-419-2622

Cc: file

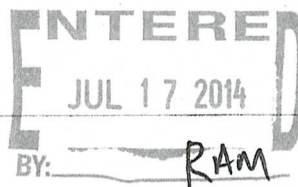

2014 JUL 16 A 10 11

COPPER FOX SOMBRERO BUTTE CO

Notice of Intent to hold the foregoing unpatented Mining Claims for 2014/2015

RECEIVED
 IN AZ STATE OFFICE
 2014 JUL 16 AM 10:17
 PHOENIX, ARIZONA

NO.	AMC	Claim Name	County	Book	Fee Number
1	371533	MAX F1	Pinal	2006	27209
2	371534	MAX F2	Pinal	2006	27210
3	371535	MAX F3	Pinal	2006	27211
4	371536	MAX F4	Pinal	2006	27212
5	371537	MAX F5	Pinal	2006	27213
6	371538	MAX 5	Pinal	2006	31771
7	371539	MAX 6	Pinal	2006	31772
8	371540	MAX 7	Pinal	2006	31773
9	371541	MAX 8	Pinal	2006	31774
10	371542	MAX 9	Pinal	2006	31775
11	371543	MAX 10	Pinal	2006	31776
12	371544	MAX 11	Pinal	2006	31777
13	371545	MAX 12	Pinal	2006	31778
14	371546	MAX 13	Pinal	2006	31779
15	371547	MAX 14	Pinal	2006	31780
16	371548	MAX 15	Pinal	2006	31781
17	371549	MAX 16	Pinal	2006	31782
18	371550	MAX 17	Pinal	2006	31783
19	371551	MAX 18	Pinal	2006	31784
20	371552	MAX 19	Pinal	2006	31785
21	371553	MAX 20	Pinal	2006	31786
22	371554	MAX 21	Pinal	2006	31787
23	371555	MAX 22	Pinal	2006	31788
24	371556	MAX 23	Pinal	2006	31789
25	371557	MAX 24	Pinal	2006	31790
26	371558	MAX 25	Pinal	2006	31791
27	371559	MAX 26	Pinal	2006	31792
28	371560	MAX 27	Pinal	2006	31793
29	371561	MAX 28	Pinal	2006	31794
30	371562	MAX 29	Pinal	2006	31795
31	371563	MAX 30	Pinal	2006	31796
32	371564	MAX 31	Pinal	2006	31797
33	396287	AMY 7	Pinal	2008	119817
34	396288	AMY 9	Pinal	2008	119819
35	396289	AMY 11	Pinal	2008	119821
36	396290	AMY 13	Pinal	2008	119823

M/S

37	396291	AMY 15	Pinal	2008	119825
38	396292	AMY 17	Pinal	2008	119827
39	357560	Magma Chief Ext.	Pinal	2003	20795
40	357561	Battle Axe	Pinal	2003	20796
41	357562	Kin Sabie	Pinal	2003	20794
42	357853	Sunset	Pinal	2003	26072
43	357854	Jewel	Pinal	2003	26073
44	357871	Hot Foot Johnny	Pinal	2003	27362
45	357873	Bagdad MS3601	Pinal	2003	29683
46	357874	Copper Reef No. 2	Pinal	2003	29682
47	358745	Copper Ridge	Pinal	2003	80487
48	358746	Copper Ridge 1	Pinal	2003	80488
49	358032	Lookout MS3601	Pinal	2003	53907
50	357875	Sunday	Pinal	2003	29684
51	359987	Sunset 1	Pinal	2004	10787
52	359988	Sunset 2	Pinal	2004	10788
53	359989	Sunset 3	Pinal	2004	10789
54	360058	Copper Triangle	Pinal	2004	67577
55	359990	Red Mountain	Pinal	2004	10786
56	420234	AMY 1	Pinal	2012	103555
57	420235	AMY 2	Pinal	2012	103556
58	420236	AMY 3	Pinal	2012	103557
59	420237	AMY 4	Pinal	2012	103558
60	420238	AMY 5	Pinal	2012	103559
61	420239	AMY 6	Pinal	2012	103560
62	420240	AMY 8	Pinal	2012	103561
63	420241	AMY 10	Pinal	2012	103562
64	420242	AMY 12	Pinal	2012	103563
65	420243	AMY 14	Pinal	2012	103564
66	420244	AMY 16	Pinal	2012	103565
67	420245	AMY 18	Pinal	2012	103566
68	420246	AMY 19	Pinal	2012	103567
69	420247	AMY 20	Pinal	2012	103568
70	420248	AMY 21	Pinal	2012	103569
71	420249	AMY 22	Pinal	2012	103570
72	420250	AMY 23	Pinal	2012	103571
73	420251	AMY 24	Pinal	2012	103572
74	420252	AMY 25	Pinal	2012	103573
75	420253	AMY 26	Pinal	2012	103574
76	420254	AMY 27	Pinal	2012	103575
77	420255	AMY 28	Pinal	2012	103576

Total number of unpatented mining claims = 77

RECEIVED
M AZ STATE OFFICE

United States Department of the Interior
Bureau of Land Management
 LANDS/RECREATION & PLANNING
 ONE N CENTRAL AVE
 PHOENIX, AZ 85004 -2203
 Phone: 602-417-9200

Receipt

No: 3078185

Transaction #: 3169415	
Date of Transaction: 07/16/2014	
CUSTOMER:	
COPPER FOX SOMBRERO BUTTE CO 11280 N SHADOW VISTA PL ORO VALLEY, AZ 85742-9678 US	

LINE #	QTY	DESCRIPTION	REMARKS	UNIT PRICE	TOTAL
1	1.00	LOCATABLE MINERALS / MINING CLAIMS- NOT NEW-UNADJUD, ONE AUTH NO. ONLY / MINING CLAIM MONEY RECEIVED CASES: AMC371533/\$11935.00	NOI (77) 2015	- n/a -	11935.00
TOTAL:					\$11,935.00

PAYMENT INFORMATION			
1	AMOUNT:	11935.00	POSTMARKED: N/A
	TYPE:	CHECK	RECEIVED: 07/16/2014
	CHECK NO:	4242	
	NAME:	CORNERSTONE LANDS DLM LLC 11280 N SHADOW VISTA PL ORO VALLEY AZ 85742-9678 US	

REMARKS

This receipt was generated by the automated BLM Collections and Billing System and is a paper representation of a portion of the official electronic record contained therein.

7-23, 2013

371533
396287
357560
357853
357871
357873
358745
358746
358032
357873
359987
360058
420234

NO. OF CLAIMS 77
AMOUNT 10,780
RECEIPT NO. 2838172
INIT. JC
** BLM-ASO**

United States Department of Interior
Bureau of Land Management
Records Section
One North Central Avenue
Suite 800
Phoenix, Arizona 85011

Notice of Intent
ANNUAL CLAIM MAINTENANCE FEES for 2013/2014,
By COPPER FOX SOMBRERO BUTTE CO

To Whom It May Concern:

The Final Rule as published in the Federal Register implements provisions of the Interior Department and related agencies, Appropriations Act of 2003 (the "Act") that requires an annual rental fee of \$140.00 for each unpatented mining claim and site located and held under the General Mining Law of 1872.

This will serve as notice that **COPPER FOX SOMBRERO BUTTE CO**, whose address for purposes of this filing is 11280 North Shadow Vista Place Tucson, Arizona 85742 intends to hold the mining claims and /or mill sites described in **Exhibit "A"** attached hereto for the assessment years **2013/2014**, by payment of the annual claim maintenance fee of \$140.00 per claim or site. Payment of **\$10,780.00** is made herewith for such assessment years for each of the unpatented lode claims and sites. The name, BLM serial number, book and page or index number of recording of the location notice is official records of Pinal County, Arizona, of which are set forth in **Exhibit "A"** attached hereto and by this reference incorporated herein.

Sincerely,

Daniel L Mead
Cornerstone Lands LLC
Agent for: COPPER FOX SOMBRERO BUTTE CO

Telephone 520-419-2622

Cc: file

ENTERED IN COMPUTER
RE 8.19.13

FILED
2013 JUL 23 P 2:12
PHOENIX, ARIZONA

COPPER FOX SOMBRERO BUTTE CO

Notice of Intent to hold the foregoing unpatented Mining Claims for 2013/2014:

NO.	AMC	Claim Name	County	Book	Fee Number
1	371533	MAX F1	Pinal	2006	27209
2	371534	MAX F2	Pinal	2006	27210
3	371535	MAX F3	Pinal	2006	27211
4	371536	MAX F4	Pinal	2006	27212
5	371537	MAX F5	Pinal	2006	27213
6	371538	MAX 5	Pinal	2006	31771
7	371539	MAX 6	Pinal	2006	31772
8	371540	MAX 7	Pinal	2006	31773
9	371541	MAX 8	Pinal	2006	31774
10	371542	MAX 9	Pinal	2006	31775
11	371543	MAX 10	Pinal	2006	31776
12	371544	MAX 11	Pinal	2006	31777
13	371545	MAX 12	Pinal	2006	31778
14	371546	MAX 13	Pinal	2006	31779
15	371547	MAX 14	Pinal	2006	31780
16	371548	MAX 15	Pinal	2006	31781
17	371549	MAX 16	Pinal	2006	31782
18	371550	MAX 17	Pinal	2006	31783
19	371551	MAX 18	Pinal	2006	31784
20	371552	MAX 19	Pinal	2006	31785
21	371553	MAX 20	Pinal	2006	31786
22	371554	MAX 21	Pinal	2006	31787
23	371555	MAX 22	Pinal	2006	31788
24	371556	MAX 23	Pinal	2006	31789
25	371557	MAX 24	Pinal	2006	31790
26	371558	MAX 25	Pinal	2006	31791
27	371559	MAX 26	Pinal	2006	31792
28	371560	MAX 27	Pinal	2006	31793
29	371561	MAX 28	Pinal	2006	31794
30	371562	MAX 29	Pinal	2006	31795
31	371563	MAX 30	Pinal	2006	31796
32	371564	MAX 31	Pinal	2006	31797
33	396287	AMY 7	Pinal	2008	119817
34	396288	AMY 9	Pinal	2008	119819
35	396289	AMY 11	Pinal	2008	119821
36	396290	AMY 13	Pinal	2008	119823

2013 JUL 23 P. 2

37	396291	AMY 15	Pinal	2008	119825
38	396292	AMY 17	Pinal	2008	119827
39	357560	Magma Chief Ext.	Pinal	2003	20795
40	357561	Battle Axe	Pinal	2003	20796
41	357562	Kin Sabie	Pinal	2003	20794
42	357853	Sunset	Pinal	2003	26072
43	357854	Jewel	Pinal	2003	26073
44	357871	Hot Foot Johny	Pinal	2003	27362
45	357873	Bagdad MS3601	Pinal	2003	29683
46	357874	Copper Reef No. 2	Pinal	2003	29682
47	357875	Copper Ridge	Pinal	2003	80487 80487 358745
48	358746	Copper Ridge 1	Pinal	2003	80488
49	358032	Lookout MS3601	Pinal	2003	53907
50	357875	Sunday	Pinal	2003	29684
51	359987	Sunset 1	Pinal	2004	10787
52	359988	Sunset 2	Pinal	2004	10788
53	359989	Sunset 3	Pinal	2004	10789
54	360058	Copper Triangle	Pinal	2004	67577
55	359990	Red Mountain	Pinal	2004	10786
56	420234	AMY 1	Pinal	2012	103555
57	420235	AMY 2	Pinal	2012	103556
58	420236	AMY 3	Pinal	2012	103557
59	420237	AMY 4	Pinal	2012	103558
60	420238	AMY 5	Pinal	2012	103559
61	420239	AMY 6	Pinal	2012	103560
62	420240	AMY 8	Pinal	2012	103561
63	420241	AMY 10	Pinal	2012	103562
64	420242	AMY 12	Pinal	2012	103563
65	420243	AMY 14	Pinal	2012	103564
66	420244	AMY 16	Pinal	2012	103565
67	420245	AMY 18	Pinal	2012	103566
68	420246	AMY 19	Pinal	2012	103567
69	420247	AMY 20	Pinal	2012	103568
70	420248	AMY 21	Pinal	2012	103569
71	420249	AMY 22	Pinal	2012	103570
72	420250	AMY 23	Pinal	2012	103571
73	420251	AMY 24	Pinal	2012	103572
74	420252	AMY 25	Pinal	2012	103573
75	420253	AMY 26	Pinal	2012	103574
76	420254	AMY 27	Pinal	2012	103575
77	420255	AMY 28	Pinal	2012	103576

Total number of unpatented mining claims = 77

2012

United States Department of the Interior
Bureau of Land Management
 LANDS/RECREATION & PLANNING
 ONE N CENTRAL AVE
 PHOENIX, AZ 85004 -2203
 Phone: 602-417-9200

Receipt

No: 2838172

Transaction #: 2923728	
Date of Transaction: 07/23/2013	
CUSTOMER:	
COPPER FOX SOMBRERO BUTTE CO 650 340 12 AVE SW CALGARY AB,NS T2R 1L5 CA	

LINE #	QTY	DESCRIPTION	REMARKS	UNIT PRICE	TOTAL
1	1.00	LOCATABLE MINERALS / MINING CLAIMS- NOT NEW-UNADJUD, ONE AUTH NO. ONLY / MINING CLAIM MONEY RECEIVED CASES: AMC371533/\$10780.00	NOI (77) 2014	- n/a -	10780.00
TOTAL:					\$10,780.00

PAYMENT INFORMATION			
1	AMOUNT:	10780.00	POSTMARKED: N/A
	TYPE:	CHECK	RECEIVED: 07/23/2013
	CHECK NO:	1004	
	NAME:	COPPER FOX SOMBRERO BUTTE CO 650 340 12 AVE SW CALGARY AB NS T2R 1L5 CA	

REMARKS

This receipt was generated by the automated BLM Collections and Billing System and is a paper representation of a portion of the official electronic record contained therein.

United States Department of the Interior
 Bureau of Land Management
 LANDS/RECREATION & PLANNING
 ONE N CENTRAL AVE
 PHOENIX, AZ 85004 -2203
 Phone: 602-417-9200

Receipt

No:

2640896

Transaction #: 2721525	
Date of Transaction: 08/27/2012	
CUSTOMER:	
COPPER FOX SOMBRERO BUTTE CO 11280 N SHADOW VISTA PL ORO VALLEY, AZ 85742-9678 US	

LINE #	QTY	DESCRIPTION	REMARKS	UNIT PRICE	TOTAL
1	1.00	LOCATABLE MINERALS / MINING CLAIMS-NOT NEW-UNADJUD, ONE AUTH NO. ONLY / MINING CLAIM MONEY RECEIVED CASES: AMC371533/\$7700.00	MAINT (55) 2013	- n/a -	7700.00
TOTAL:					\$7,700.00

PAYMENT INFORMATION					
1	AMOUNT:	7700.00	POSTMARKED:	N/A	
	TYPE:	CHECK	RECEIVED:	08/27/2012	
	CHECK NO:	000233			
	NAME:	COPPER FOX SOMBRERO BUTTE CO 11280 N SHADOW VISTA PL ORO VALLEY AZ 85742-9678 US			

REMARKS

This receipt was generated by the automated BLM Collections and Billing System and is a paper representation of a portion of the official electronic record contained therein.

37	396291	AMY 15	Pinal	2008	119825
38	396292	AMY 17	Pinal	2008	119827
39	357560	Magma Chief Ext.	Pinal	2003	20795
40	357561	Battle Axe	Pinal	2003	20796
41	357562	Kin Sabie	Pinal	2003	20794
42	357853	Sunset	Pinal	2003	26072
43	357854	Jewel	Pinal	2003	26073
44	357871	Hot Foot Johny	Pinal	2003	27362
45	357873	Bagdad MS3601	Pinal	2003	29683
46	357874	Copper Reef No. 2	Pinal	2003	29682
47	357875	Copper Ridge	Pinal	2003	80487
48	358746	Copper Ridge 1	Pinal	2003	80488
49	358032	Lookout MS3601	Pinal	2003	53907
50	357875	Sunday	Pinal	2003	29684
51	359987	Sunset 1	Pinal	2004	10787
52	359988	Sunset 2	Pinal	2004	10788
53	359989	Sunset 3	Pinal	2004	10789
54	360058	Copper Triangle	Pinal	2004	67577
55	359990	Red Mountain	Pinal	2004	10786

358746

Total number of unpatented mining claims = 55

SC

RECEIVED
BLM AZ STATE OFFICE
2012 AUG 21 A 10:21
PHOENIX, ARIZONA

"EXHIBIT A"

COPPER FOX SOMBRERO BUTTE CO

Notice of Intent to hold the foregoing unpatented Mining Claims for 2012/2013:

NO.	AMC	Claim Name	County	Book	Fee Number
1	371533	MAX F1	Pinal	2006	27209
2	371534	MAX F2	Pinal	2006	27210
3	371535	MAX F3	Pinal	2006	27211
4	371536	MAX F4	Pinal	2006	27212
5	371537	MAX F5	Pinal	2006	27213
6	371538	MAX 5	Pinal	2006	31771
7	371539	MAX 6	Pinal	2006	31772
8	371540	MAX 7	Pinal	2006	31773
9	371541	MAX 8	Pinal	2006	31774
10	371542	MAX 9	Pinal	2006	31775
11	371543	MAX 10	Pinal	2006	31776
12	371544	MAX 11	Pinal	2006	31777
13	371545	MAX 12	Pinal	2006	31778
14	371546	MAX 13	Pinal	2006	31779
15	371547	MAX 14	Pinal	2006	31780
16	371548	MAX 15	Pinal	2006	31781
17	371549	MAX 16	Pinal	2006	31782
18	371550	MAX 17	Pinal	2006	31783
19	371551	MAX 18	Pinal	2006	31784
20	371552	MAX 19	Pinal	2006	31785
21	371553	MAX 20	Pinal	2006	31786
22	371554	MAX 21	Pinal	2006	31787
23	371555	MAX 22	Pinal	2006	31788
24	371556	MAX 23	Pinal	2006	31789
25	371557	MAX 24	Pinal	2006	31790
26	371558	MAX 25	Pinal	2006	31791
27	371559	MAX 26	Pinal	2006	31792
28	371560	MAX 27	Pinal	2006	31793
29	371561	MAX 28	Pinal	2006	31794
30	371562	MAX 29	Pinal	2006	31795
31	371563	MAX 30	Pinal	2006	31796
32	371564	MAX 31	Pinal	2006	31797
33	396287	AMY 7	Pinal	2008	119817
34	396288	AMY 9	Pinal	2008	119819
35	396289	AMY 11	Pinal	2008	119821
36	396290	AMY 13	Pinal	2008	119823

827, 2012

United States Department of Interior
Bureau of Land Management
Records Section
One North Central Avenue
Suite 800
Phoenix, Arizona 85011

NO. OF CLAIMS 55
AMOUNT 7700.
RECEIPT NO. 2640896
INIT. SC

** BLM-ASO**

358745
371533
396287
357560
357853
357873
357871
358746
358032
359987
360058

Notice of Intent
ANNUAL CLAIM MAINTENANCE FEES for 2012/2013,
By COPPER FOX SOMBRERO BUTTE CO

To Whom It May Concern:

The Final Rule as published in the Federal Register implements provisions of the Interior Department and related agencies, Appropriations Act of 2003 (the "Act") that requires an annual rental fee of \$140.00 for each unpatented mining claim and site located and held under the General Mining Law of 1872.

This will serve as notice that **COPPER FOX SOMBRERO BUTTE CO**, whose address for purposes of this filing is 11280 North Shadow Vista Place Tucson, Arizona 85742 intends to hold the mining claims and /or mill sites described in **Exhibit "A"** attached hereto for the assessment years **2012/2013**, by payment of the annual claim maintenance fee of \$140.00 per claim or site. Payment of **\$7,700.00** is made herewith for such assessment years for each of the unpatented lode claims and sites. The name, BLM serial number, book and page or index number of recording of the location notice is official records of Pinal County, Arizona, of which are set forth in **Exhibit "A"** attached hereto and by this reference incorporated herein.

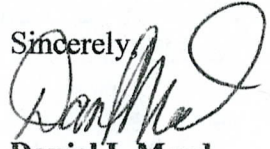
Sincerely

Daniel L Mead
Cornerstone Lands LLC
Agent for: COPPER FOX SOMBRERO BUTTE CO

Telephone 520-419-2622

Cc: file

RECEIVED
BLM AZ STATE OFFICE
2012 AUG 27 A 10: 21
PHOENIX, ARIZONA

9/10/2012 TS
ENTERED INTO COMPUTER

AMC 396287

Timothy M. Marsh
4750 North Bonanza Avenue
Tucson, AZ 85749

April 17, 2012

U.S. Bureau of Land Management
Arizona State Office
One North Central Avenue
Phoenix, AZ, 85004-4427

RE: Notice of Transfer of Interest

To Whom It May Concern:

Notice is hereby given pursuant to 43 C.F.R. § 3833.32(b) that, by the enclosed Quitclaim Deed:

1. Timothy M. Marsh, dba Bell Resources Corporation-US, transferred its interest in the 6 "AMY" claims (AMC396287 through AMC396292) to Bell Resources (Nevada) Corporation on April 17, 2012 as recorded as Fee Number 2012-031698.
2. The Claims transferred are in Pinal County, Arizona, the names of which and the serial numbers assigned to each claim are set forth on the enclosed Quitclaim Deed.
3. The name and mailing address for the transferee is Timothy M. Marsh, 4750 North Bonanza Avenue, Tucson, Arizona 85749.

A fee attached hereto of \$60.00 is intended to cover the transfer of the 6 unpatented lode mining claims, as per the table at 43 C.F.R. § 3830.21.

Sincerely,

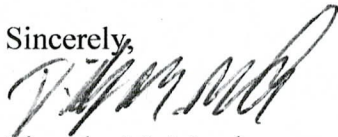

Timothy M. Marsh
Transferee

PHOENIX, ARIZONA

2012 APR 18 A 9:56

RECEIVED
BLM/ARIZONA STATE OFFICE

ENTERED INTO COMPUTER

5/17/12 AT

4/30

United States Department of the Interior
 Bureau of Land Management
 LANDS/RECREATION & PLANNING
 ONE N CENTRAL AVE
 PHOENIX, AZ 85004 -2203
 Phone: 602-417-9200

Amc 371533
 Receipt 396287

No: 2419982

Transaction #: 2495405	
Date of Transaction: 08/30/2011	
CUSTOMER:	
BELL RESOURCES (NEVADA) CORP 9420 E PLACITA OAXACA TUCSON, AZ 85749-9272 US	SEP 08 2011

LINE #	QTY	DESCRIPTION	REMARKS	UNIT PRICE	TOTAL
1	1.00	LOCATABLE MINERALS / MINING CLAIMS-NOT NEW-UNADJUD, ONE AUTH NO. ONLY / MINING CLAIM MONEY RECEIVED CASES: AMC371538/\$5320.00	MAINT 2012/38	- n/a -	5320.00
TOTAL:					\$5,320.00

PAYMENT INFORMATION			
1	AMOUNT:	5320.00	POSTMARKED: N/A
	TYPE:	CHECK	RECEIVED: 08/30/2011
	CHECK NO:	1284	
	NAME:	BELL RESOURCES (NEVADA) CORP 9420 E PLACITA OAXACA TUCSON AZ 85749-9272 US	

REMARKS

This receipt was generated by the automated BLM Collections and Billing System and is a paper representation of a portion of the official electronic record contained therein.



Timothy M. Marsh
4750 N. Bonanza Ave.
Tucson, AZ 85749

August 29, 2011

U.S. Department of Interior
Bureau of Land Management
Business and Support Services Division
One North Central Avenue
Phoenix, AZ 85004-2203

Dear Sir or Madam,

Enclosed please find a check for US\$ 5,320.00 to cover the cost of annual maintenance fees of \$140.00 each on 38 unpatented lode mining claims, further described in the attached documentation. Would you please be so kind as to place your time and date stamp on the accompanying AFFIDAVIT OF PAYMENT attesting to your timely receipt of these funds?

Thank you for your assistance with my request.

Sincerely,

A handwritten signature in black ink, appearing to read "Timothy M. Marsh".

Timothy M. Marsh, PhD, P.E.
President
Bell Copper Corporation

RECEIVED
BLM AZ STATE OFFICE
2011 AUG 30 A 11:58
PHOENIX, ARIZONA

When recorded return to:

Timothy M. Marsh
4750 N. Bonanza Ave.
Tucson, AZ 85749

480-570-7077
tim.marsh@cox.net

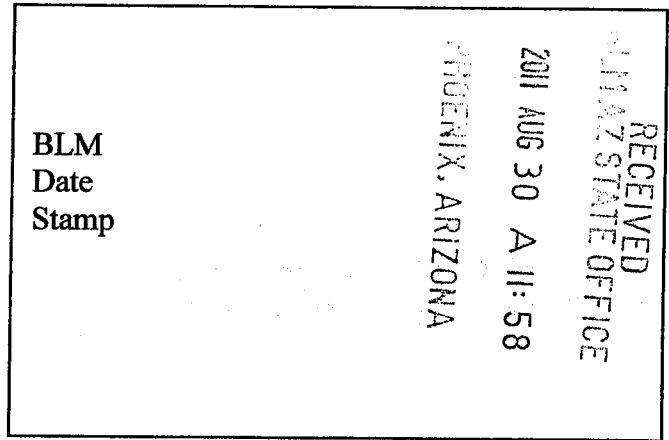

Affidavit of Payment of Mining Claim Annual Maintenance Fees

Bell Copper Corporation hereby remits payment of \$5,320.00 in lieu of annual assessment work on 38 unpatented mining claims named Max 5 through Max 31, Max F1 through Max F5, and AMY-7, AMY-9, AMY-11, AMY-13, AMY-15, and AMY-17, having AMC numbers listed in Appendix A of this Affidavit. The claims are located in the Bunker Hill mining district, Pinal County, Arizona, in Township 8 South, Range 18 East, G&SRBM.

Timothy M. Marsh
Bell Copper Corporation

August 29, 2011
Date

Appendix A
Bell Copper Corporation
Annual Maintenance Fees

ENTERED INTO COMPUTER

SEP 08 2011

m

Claim Name	BLM AMC#
Max 5	371538
Max 6	371539
Max 7	371540
Max 8	371541
Max 9	371542
Max 10	371543
Max 11	371544
Max 12	371545
Max 13	371546
Max 14	371547
Max 15	371548
Max 16	371549
Max 17	371550
Max 18	371551
Max 19	371552
Max 20	371553
Max 21	371554
Max 22	371555
Max 23	371556
Max 24	371557
Max 25	371558
Max 26	371559
Max 27	371560
Max 28	371561
Max 29	371562
Max 30	371563
Max 31	371564
Max F1	371533 ✓
Max F2	371534 ✓
Max F3	371535 ✓
Max F4	371536 ✓
Max F5	371537 ✓
AMY 7	396287
AMY 9	396288
AMY 11	396289
AMY 13	396290
AMY 15	396291
AMY 17	396292

RECEIVED
BLM AZ STATE OFFICE
2011 AUG 30 A 11:58
PHOENIX, ARIZONA

#2419982

38
JMC



Amc

371533

396287

Timothy M. Marsh
1780-400 Burrard Street
Vancouver, B.C. V6C3A6
Canada

August 23, 2010

U.S. Department of Interior
Bureau of Land Management
Business and Support Services Division
One North Central Avenue
Phoenix, AZ 85004-2203

Dear Sir or Madam,

Enclosed please find a check for US\$ 5,320.00 to cover the cost of annual maintenance fees of \$140.00 each on 38 unpatented lode mining claims, further described in the attached documentation. Would you please be so kind as to place your time and date stamp on the accompanying AFFIDAVIT OF PAYMENT attesting to your timely receipt of these funds?

Thank you for your assistance with my request.

Sincerely,

Timothy M. Marsh, PhD, P.E.
President
Bell Copper Corporation

ENTERED INTO COMPUTER
SEP 02 2010

PHOENIX, ARIZONA

2010 AUG 23 P 1:34

RECEIVED
BLM AZ STATE OFFICE

NO. OF CLAIMS 38
AMOUNT 5320.00
RECEIPT NO. 2197513
INIT. EM

** BLM-ASO**

Timothy M. Marsh
9420 East Placita Oaxaca
Tucson, AZ
520-749-3144
tim.marsh@cox.net

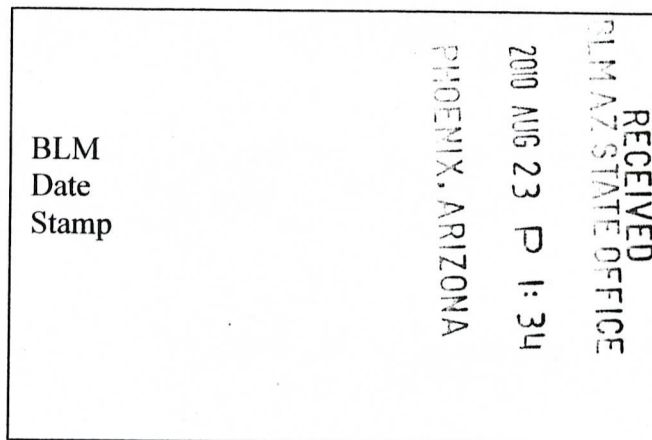

Affidavit of Payment of Mining Claim Annual Maintenance Fees

Bell Copper Corporation hereby remits payment of \$5,320.00 in lieu of annual assessment work on 38 unpatented mining claims named Max 5 through Max 31, Max F1 through Max F5, and AMY-7, AMY-9, AMY-11, AMY-13, AMY-15, and AMY-17, having AMC numbers listed in Appendix A of this Affidavit. The claims are located in the Bunker Hill mining district, Pinal County, Arizona, in Township 8 South, Range 18 East, G&SRBM.

Timothy M. Marsh
Bell Copper Corporation

August 23, 2010
Date

Appendix A
 Bell Copper Corporation
 Annual Maintenance Fees

Claim Name	BLM AMC#
Max 5	371538
Max 6	371539
Max 7	371540
Max 8	371541
Max 9	371542
Max 10	371543
Max 11	371544
Max 12	371545
Max 13	371546
Max 14	371547
Max 15	371548
Max 16	371549
Max 17	371550
Max 18	371551
Max 19	371552
Max 20	371553
Max 21	371554
Max 22	371555
Max 23	371556
Max 24	371557
Max 25	371558
Max 26	371559
Max 27	371560
Max 28	371561
Max 29	371562
Max 30	371563
Max 31	371564
Max F1	371533
Max F2	371534
Max F3	371535
Max F4	371536
Max F5	371537
AMY 7	396287
AMY 9	396288
AMY 11	396289
AMY 13	396290
AMY 15	396291
AMY 17	396292

RECEIVED
 BLM AZ STATE OFFICE
 2010 AUG 23 P 1:34
 PHOENIX, ARIZONA

ENTERED INTO COMPUTER

 SEP 02 2010

United States Department of the Interior
Bureau of Land Management
 LANDS/RECREATION & PLANNING
 ONE N CENTRAL AVE
 PHOENIX, AZ 85004 -2203
 Phone:

Receipt

No: 2197513

Transaction #: 2267384		ENTERED INTO COMPUTER
Date of Transaction: 08/23/2010		
CUSTOMER:	TIMOTHY M MARSH 9420 E PLACITA OAXACA TUCSON, AZ 85749-9272 US	SEP 02 2010

LINE #	QTY	DESCRIPTION	REMARKS	UNIT PRICE	TOTAL
1	1.00	LOCATABLE MINERALS / MINING CLAIMS- NOT NEW-UNADJUD, ONE AUTH NO. ONLY / MINING CLAIM MONEY RECEIVED CASES: AMC371538/\$5320.00	2011 MAINT (38)	- n/a -	5320.00
TOTAL:					\$5,320.00

PAYMENT INFORMATION			
1	AMOUNT:	5320.00	POSTMARKED: N/A
	TYPE:	CHECK	RECEIVED: 08/23/2010
	CHECK NO:	1165	
	NAME:	MARSH, TIMOTHY M 9420 E PLACITA OAXACA TUCSON AZ 85749-9272 US	

REMARKS

This receipt was generated by the automated BLM Collections and Billing System and is a paper representation of a portion of the official electronic record contained therein.



Amc 371533

396287

Timothy M. Marsh
1780-400 Burrard Street
Vancouver, B.C. V6C3A6
Canada

August 21, 2009

U.S. Department of Interior
Bureau of Land Management
Business and Support Services Division
One North Central Avenue
Phoenix, AZ 85004-2203

Dear Sir or Madam,

Enclosed please find a check for US\$ 5,320.00 to cover the cost of annual maintenance fees of \$140.00 each on 38 unpatented lode mining claims, further described in the attached documentation. Would you please be so kind as to place your time and date stamp on the accompanying AFFIDAVIT OF PAYMENT attesting to your timely receipt of these funds?

Thank you for your assistance with my request.

Sincerely,

Timothy M. Marsh, PhD, P.E.
VP Exploration
Bell Copper Corporation

ENTERED INTO COMPUTER
AUG 24 2009 PB

PHOENIX, ARIZONA

2009 AUG 21 P 3:47

RECEIVED
BLM AZ STATE OFFICE

Timothy M. Marsh
9420 East Placita Oaxaca
Tucson, AZ
520-749-3144
tim.marsh@cox.net

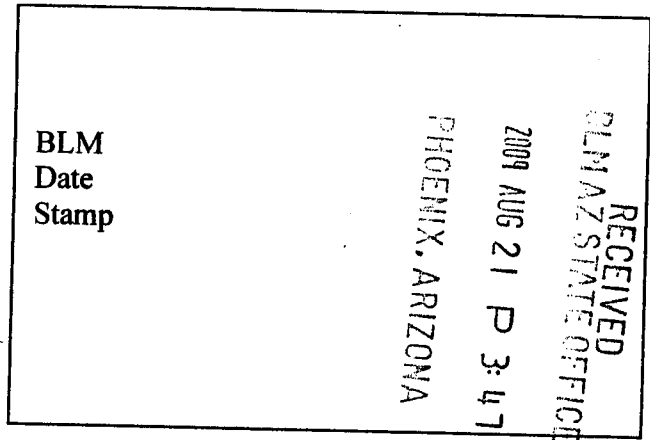

Affidavit of Payment of Mining Claim Annual Maintenance Fees

Bell Copper Corporation hereby remits payment of \$5,320.00 in lieu of annual assessment work on 38 unpatented mining claims named Max 5 through Max 31, Max F1 through Max F5, and AMY-7, AMY-9, AMY-11, AMY-13, AMY-15, and AMY-17, having AMC numbers listed in Appendix A of this Affidavit. The claims are located in the Bunker Hill mining district, Pinal County, Arizona, in Township 8 South, Range 18 East, G&SRBM.

Timothy M. Marsh
Bell Copper Corporation

Date

Appendix A
 Bell Copper Corporation
 Annual Maintenance Fees

Claim Name	BLM AMC#
/ Max 5	371538
/ Max 6	371539
/ Max 7	371540
/ Max 8	371541
/ Max 9	371542
/ Max 10	371543
/ Max 11	371544
/ Max 12	371545
/ Max 13	371546
/ Max 14	371547
/ Max 15	371548
/ Max 16	371549
/ Max 17	371550
/ Max 18	371551
/ Max 19	371552
/ Max 20	371553
/ Max 21	371554
/ Max 22	371555
/ Max 23	371556
/ Max 24	371557
/ Max 25	371558
/ Max 26	371559
/ Max 27	371560
/ Max 28	371561
/ Max 29	371562
/ Max 30	371563
/ Max 31	371564
/ Max F1	371533
/ Max F2	371534
/ Max F3	371535
/ Max F4	371536
/ Max F5	371537
/ AMY 7	396287
/ AMY 9	396288
/ AMY 11	396289
/ AMY 13	396290
/ AMY 15	396291
/ AMY 17	396292

RECEIVED
 PLM AZ STATE OFFICE
 2009 AUG 21 P 3:47
 PHOENIX, ARIZONA

Lead #
 371533
 396287

371533 - 564
 396287 - 292

38/50

ENTERED INTO COMPUTER
 AUG 24 2009 (B)

United States Department of the Interior
Bureau of Land Management
 BUSINESS & SUPPORT SVCS DIV
 ONE N CENTRAL AVE SUITE 800
 PHOENIX, AZ 85004 -4427
 Phone: (602) 417-9200

Receipt

No: 1984489

Transaction #: 2048582	ENTERED INTO COMPUTER
Date of Transaction: 08/21/2009	
CUSTOMER: TIMOTHY M MARSH 9420 E PLACITA OAXACA TUCSON, AZ 85749-9272 US	AUG 24 2009 JB

LINE #	QTY	DESCRIPTION	REMARKS	UNIT PRICE	TOTAL
1	1.00	LOCATABLE MINERALS / MINING CLAIMS-NOT NEW-UNADJUD, ONE AUTH NO. ONLY / MINING CLAIM MONEY RECEIVED CASES: AMC371538/\$5320.00	MAINT (38)	- n/a -	5320.00
TOTAL:					\$5,320.00

PAYMENT INFORMATION				
1	AMOUNT:	5320.00	POSTMARKED:	N/A
	TYPE:	CHECK	RECEIVED:	08/21/2009
	CHECK NO:	1054		
	NAME:	MARSH, TIMOTHY M 9420 E PLACITA OAXACA TUCSON AZ 85749-9272 US		

REMARKS

This receipt was generated by the automated BLM Collections and Billing System and is a paper representation of a portion of the official electronic record contained therein.

NOTICE!!

These documents have been scanned!

Do not place un-scanned documents beneath this notice!

Do not remove this notice from this file!

GPO Jacket No. 560-102
Print Order 61540
Rise Business Services, LLC
Job=AZ15 5/22/2019



Box Number= AZ15076



Claim Begin-End: AMC396287-AMC396292

5 Miscellaneous



AZ15076-10

AMC396025-AMC396393

**NO
DOCUMENTS
FOUND**

NO DOCUMENTS FOUND
NO DOCUMENTS FOUND

NOTICE!!

These documents have been scanned!

Do not place un-scanned documents beneath this notice!

Do not remove this notice from this file!

GPO Jacket No. 560-102
Print Order 61540
Rise Business Services, LLC
Job=AZ15 5/22/2019



Box Number= AZ15076



Claim Begin-End: AMC396287-AMC396292

6 Location Notices-Amendments and Supporting Documents



AZ15076-10

AMC396025-AMC396393

MINING CLAIM STATUS REPORT

MTP CHECKED BY HMC
GEO CHECKED BY HME

DATA ENTRY _____

LEAD SERIAL NO. AMC 396287 THROUGH AMC 296292

# <u>6</u>	LODE	LOCATION FEE @ \$30 =	\$ <u>180 -</u>
#	PLACER	PROCESSING FEE @ \$15 =	\$ <u>90 -</u>
#	ASSOCIATION PL	MAINTENANCE FEE @ \$125 =	\$ <u>750 -</u>
#	MILL SITE	OVERAGE	\$ _____
#	TUNNEL SITE	SHORTAGE	\$ _____
		OTHER FEES	\$ _____
	ENOUGH LOCATORS	TOTAL	\$ <u>1,020 -</u>

YES [] NO [] _____

OVER-THE-COUNTER MAIL [] TIMELY FILED: YES [] NO []

LEGAL DESCRIPTION: T 85 R 18E SEC 26
 T _____ R _____ SEC _____
 T _____ R _____ SEC _____
 T _____ R _____ SEC _____

BLM [] FOREST SERVICE [] _____ SUBJ TO PL 359: YES [] NO []

WILDERNESS AREA: NO [] YES [] _____

SPLIT ESTATE: SX [] PX [] SRHA [] OTHER [] _____ N/A []
 PROPER NOTICE FILED IF LOCATED ON SRHA LANDS-YES [] NO [] N/A []

RECONVEYED MINERALS ON BLM LANDS REQUIRE OPENING ORDERS
 FROM 1944 TO 1993. OPEN TO ENTRY ON: _____ N/A []

COMMENTS/STATUS: VOID [] PARTIALLY VOID [] PVT MINERALS []
 WITHDRAWN LANDS [] OTHER [] _____

86 days
1113685 - mins OK. Taylor Grazing Act.

Claimant acknowledges that portions of the following claim(s) site(s) may be void or voidable. _____

Signature of claimant _____
 FINAL ADJUDICATION ✓ DATE 2/3/2010

AMC 396287

When recorded return to:
 Timothy Marsh
 9420 E. Placita Oaxaca
 Tucson, AZ 85749



OFFICIAL RECORDS OF
 PINAL COUNTY RECORDER
 LAURA DEAN-LYTLER

DATE/TIME: 12/17/08 1013
 FEE: \$14.00
 PAGES: 1
 FEE NUMBER: 2008-119817

LOCATION NOTICE FOR LODE MINING CLAIM

NOTICE IS HEREBY GIVEN that the AMY-7 lode mining claim has been located by Timothy Marsh, Bell Resources (Nevada) Corporation, whose current mailing address is 9420 E. Placita Oaxaca, Tucson, Arizona, 85749. The general course of this claim is East - West, and it is situated in Pinal County, Arizona. This claim is 1500 feet in length and 600 feet in width. This claim runs from the location monument on which this location notice is posted approximately 1470 feet in an easterly direction to the East end line and 30 feet in a westerly direction to the West end line. This claim is marked by six additional monuments, one at each corner and one at the center of each end line.

The location monument on which this notice is posted is situated within Section 26, Township 8 South, Range 18 East, Gila and Salt River Baseline and Meridian, Arizona, and this claim occupies the following quarter section(s), section(s), Township, and Range:

Quarter Section	Section	Township	Range
<u>NE</u> 1/4	<u>26</u> Section	8 South	18 East
<u>NW</u> 1/4	<u>25</u> Section	8 South	18 East
1/4	Section	8 South	18 East
1/4	Section	8 South	18 East

The northeast corner of this claim is 100 feet east and 1700 feet south of the northeast corner of Section 26, Township 8 South, Range 18 East, Gila and Salt River Baseline and Meridian.

DATED AND POSTED on the ground this 16th day of December, 2008, at 12:51 p.m.

Timothy Marsh
 Timothy Marsh

T. 8 S., R. 18 E. G&SRBM

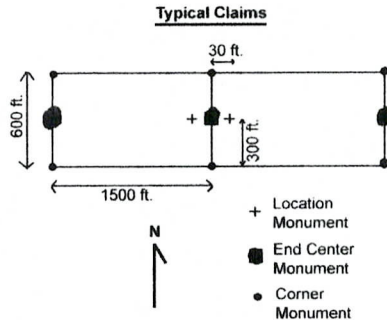
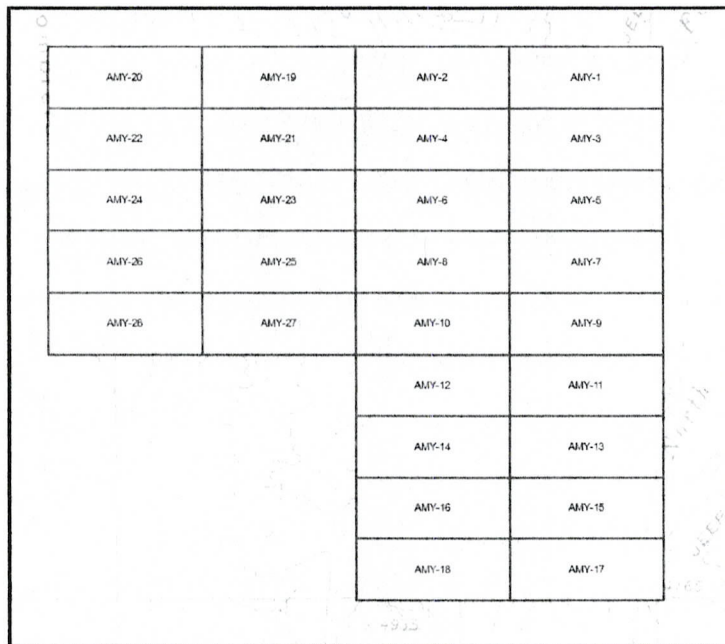

RECEIVED
 B.L.M. AZ STATE OFFICE
 2009 MAR 12 A 11:17
 PHOENIX, AZ

AMC 396287

Scale: 1 inch = 2,000 feet

The above map depicts the AMY-7 lode mining claim, which is located in Section 26, Township 8 South, Range 18 East, Gila and Salt River Baseline and Meridian, Pinal County, Arizona. The claim corners, end centers, and location monuments are marked by 2 inch by 2 inch by 5-foot wooden posts with aluminum tags. The bearings and distances between claim corners are as depicted on the map.

When recorded return to:
 Timothy Marsh
 9420 E. Placita Oaxaca
 Tucson, AZ 85749



OFFICIAL RECORDS OF
 PINAL COUNTY RECORDER
 LAURA DEAN-LYTLÉ

DATE/TIME: 12/17/08 1013
 FEE: \$14.00
 PAGES: 1
 FEE NUMBER: 2008-119819

LOCATION NOTICE FOR LODE MINING CLAIM

NOTICE IS HEREBY GIVEN that the AMY-9 lode mining claim has been located by Timothy Marsh, Bell Resources (Nevada) Corporation, whose current mailing address is 9420 E. Placita Oaxaca, Tucson, Arizona, 85749. The general course of this claim is East - West, and it is situated in Pinal County, Arizona. This claim is 1500 feet in length and 600 feet in width. This claim runs from the location monument on which this location notice is posted approximately 1470 feet in an easterly direction to the East end line and 30 feet in a westerly direction to the West end line. This claim is marked by six additional monuments, one at each corner and one at the center of each end line.

The location monument on which this notice is posted is situated within Section 26, Township 8 South, Range 18 East, Gila and Salt River Baseline and Meridian, Arizona, and this claim occupies the following quarter section(s), section(s), Township, and Range:

Quarter Section	Section	Township	Range
<u>NE</u> ¼	<u>26</u> Section	8 South	18 East
<u>NW</u> ¼	<u>25</u> Section	8 South	18 East
<u>SE</u> ¼	<u>26</u> Section	8 South	18 East
<u>SW</u> ¼	<u>25</u> Section	8 South	18 East

The northeast corner of this claim is 100 feet east and 2300 feet south of the northeast corner of Section 26, Township 8 South, Range 18 East, Gila and Salt River Baseline and Meridian.

DATED AND POSTED on the ground this 16th day of December, 2008, at 12:22 p.m.

 Timothy Marsh

T. 8 S., R. 18 E. G&SRBM

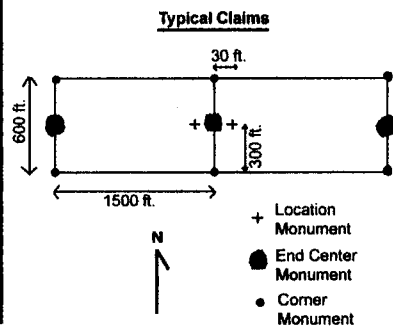
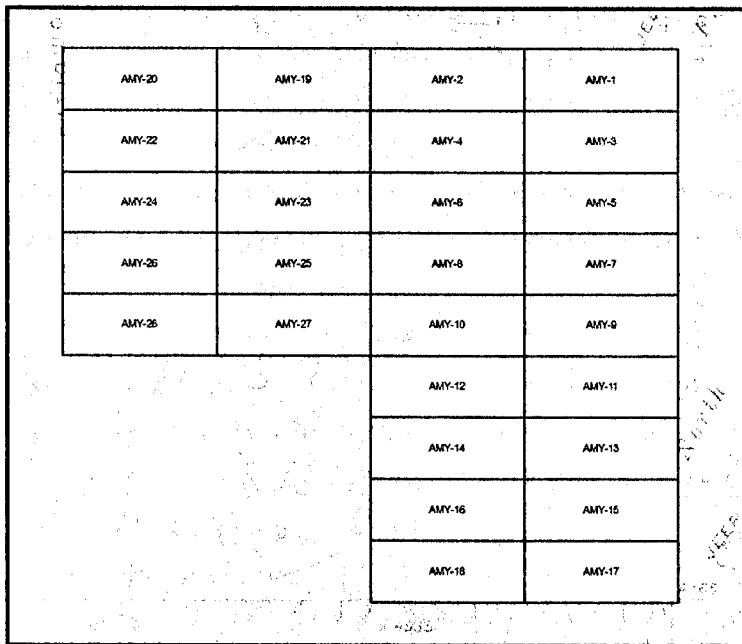

RECEIVED
 B.L.M. AZ STATE OFFICE
 2009 MAR 12 A 11:17
 PHOENIX, AZ

AMC 396288

Scale: 1 inch = 2,000 feet

The above map depicts the AMY-9 lode mining claim, which is located in Section 26, Township 8 South, Range 18 East, Gila and Salt River Baseline and Meridian, Pinal County, Arizona. The claim corners, end centers, and location monuments are marked by 2 inch by 2 inch by 5-foot wooden posts with aluminum tags. The bearings and distances between claim corners are as depicted on the map.

When recorded return to:
 Timothy Marsh
 9420 E. Placita Oaxaca
 Tucson, AZ 85749



OFFICIAL RECORDS OF
 PINAL COUNTY RECORDER
 LAURA DEAN-LYTL

DATE/TIME: 12/17/08 1013
 FEE: \$14.00
 PAGES: 1
 FEE NUMBER: 2008-119821

LOCATION NOTICE FOR LODE MINING CLAIM

NOTICE IS HEREBY GIVEN that the AMY-11 lode mining claim has been located by Timothy Marsh, Bell Resources (Nevada) Corporation, whose current mailing address is 9420 E. Placita Oaxaca, Tucson, Arizona, 85749. The general course of this claim is East - West, and it is situated in Pinal County, Arizona. This claim is 1500 feet in length and 600 feet in width. This claim runs from the location monument on which this location notice is posted approximately 1470 feet in an easterly direction to the East end line and 30 feet in a westerly direction to the West end line. This claim is marked by six additional monuments, one at each corner and one at the center of each end line.

The location monument on which this notice is posted is situated within Section 26, Township 8 South, Range 18 East, Gila and Salt River Baseline and Meridian, Arizona, and this claim occupies the following quarter section(s), section(s), Township, and Range:

Quarter Section	Section	Township	Range
<u>1/4</u>	<u>Section</u>	8 South	18 East
<u>1/4</u>	<u>Section</u>	8 South	18 East
<u>SE 1/4</u>	<u>26 Section</u>	8 South	18 East
<u>SW 1/4</u>	<u>25 Section</u>	8 South	18 East

The northeast corner of this claim is 100 feet east and 2900 feet south of the northeast corner of Section 26, Township 8 South, Range 18 East, Gila and Salt River Baseline and Meridian.

DATED AND POSTED on the ground this 16th day of December, 2008, at 11:55 a.m./~~pm~~.

Timothy Marsh
 Timothy Marsh

T. 8 S., R. 18 E. G&SRBM

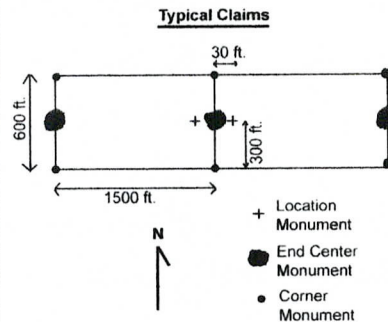
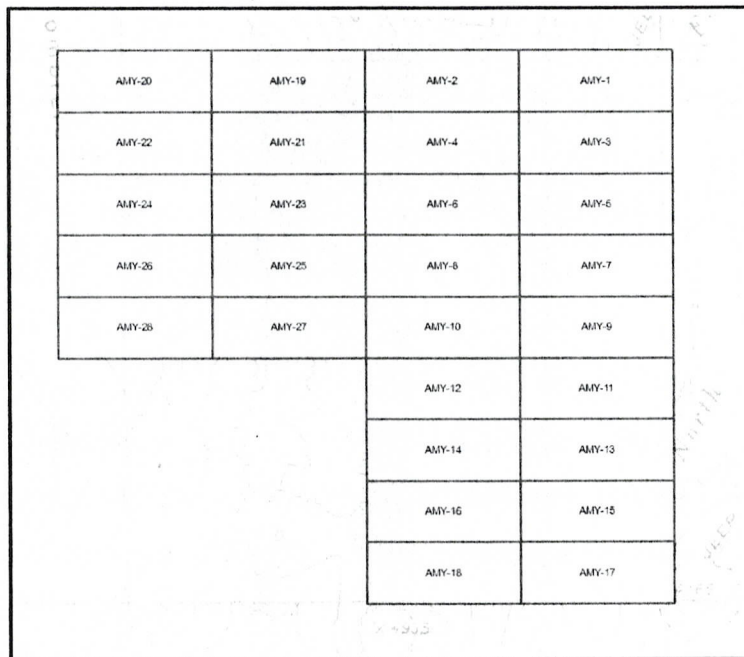

RECEIVED
 B.L.M. AZ STATE OFFICE
 2009 MAR 12 A 11:17
 PHOENIX, AZ

AMC 396289

Scale: 1 inch = 2,000 feet

The above map depicts the AMY-11 lode mining claim, which is located in Section 26, Township 8 South, Range 18 East, Gila and Salt River Baseline and Meridian, Pinal County, Arizona. The claim corners, end centers, and location monuments are marked by 2 inch by 2 inch by 5-foot wooden posts with aluminum tags. The bearings and distances between claim corners are as depicted on the map.

When recorded return to:
 Timothy Marsh
 9420 E. Placita Oaxaca
 Tucson, AZ 85749



OFFICIAL RECORDS OF
 PINAL COUNTY RECORDER
 LAURA DEAN-LYTTLE

DATE/TIME: 12/17/08 1013
 FEE: \$14.00
 PAGES: 1
 FEE NUMBER: 2008-119823

LOCATION NOTICE FOR LODE MINING CLAIM

NOTICE IS HEREBY GIVEN that the AMY-13 lode mining claim has been located by Timothy Marsh, Bell Resources (Nevada) Corporation, whose current mailing address is 9420 E. Placita Oaxaca, Tucson, Arizona, 85749. The general course of this claim is East - West, and it is situated in Pinal County, Arizona. This claim is 1500 feet in length and 600 feet in width. This claim runs from the location monument on which this location notice is posted approximately 1470 feet in an easterly direction to the East end line and 30 feet in a westerly direction to the West end line. This claim is marked by six additional monuments, one at each corner and one at the center of each end line.

The location monument on which this notice is posted is situated within Section 26, Township 8 South, Range 18 East, Gila and Salt River Baseline and Meridian, Arizona, and this claim occupies the following quarter section(s), section(s), Township, and Range:

Quarter Section	Section	Township	Range
<u>1/4</u>	<u>Section</u>	8 South	18 East
<u>1/4</u>	<u>Section</u>	8 South	18 East
<u>SE 1/4</u>	<u>26</u> Section	8 South	18 East
<u>SW 1/4</u>	<u>25</u> Section	8 South	18 East

The northeast corner of this claim is 100 feet east and 3500 feet south of the northeast corner of Section 26, Township 8 South, Range 18 East, Gila and Salt River Baseline and Meridian.

DATED AND POSTED on the ground this 16th day of December, 2008, at 11:27 a.m. ~~0208~~.

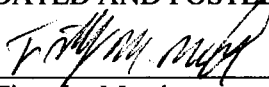
 Timothy Marsh

T. 8 S., R. 18 E. G&SRBM

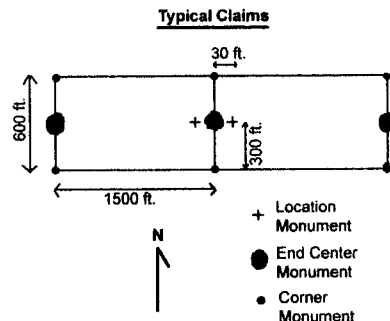
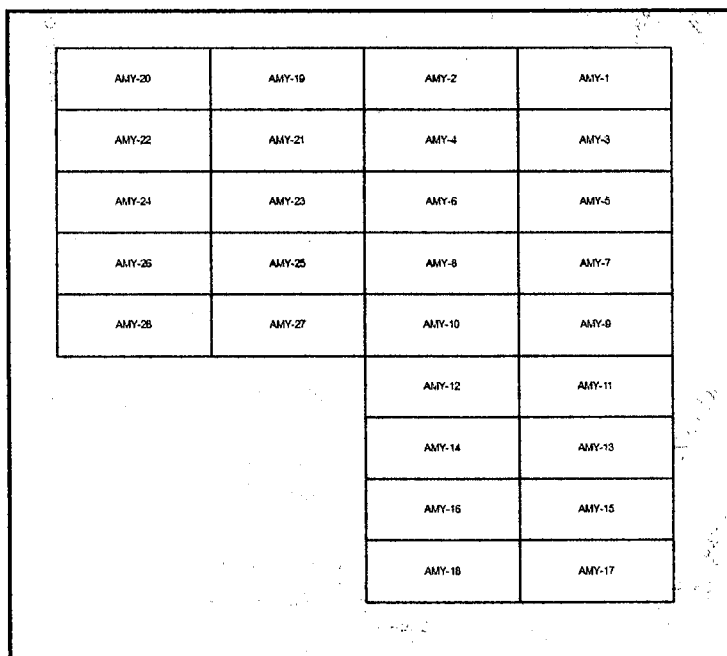

RECEIVED
 B.L.M. AZ STATE OFFICE
 2009 MAR 12 A 11:17
 PHOENIX, AZ

AMC 396290

Scale: 1 inch = 2,000 feet

The above map depicts the AMY-13 lode mining claim, which is located in Section 26, Township 8 South, Range 18 East, Gila and Salt River Baseline and Meridian, Pinal County, Arizona. The claim corners, end centers, and location monuments are marked by 2 inch by 2 inch by 5-foot wooden posts with aluminum tags. The bearings and distances between claim corners are as depicted on the map.

When recorded return to:
 Timothy Marsh
 9420 E. Placita Oaxaca
 Tucson, AZ 85749



OFFICIAL RECORDS OF
 PINAL COUNTY RECORDER
 LAURA DEAN-LYTTLE

DATE/TIME: 12/17/08 1013
 FEE: \$14.00
 PAGES: 1
 FEE NUMBER: 2008-119825

LOCATION NOTICE FOR LODE MINING CLAIM

NOTICE IS HEREBY GIVEN that the AMY-15 lode mining claim has been located by Timothy Marsh, Bell Resources (Nevada) Corporation, whose current mailing address is 9420 E. Placita Oaxaca, Tucson, Arizona, 85749. The general course of this claim is East - West, and it is situated in Pinal County, Arizona. This claim is 1500 feet in length and 600 feet in width. This claim runs from the location monument on which this location notice is posted approximately 1470 feet in an easterly direction to the East end line and 30 feet in a westerly direction to the West end line. This claim is marked by six additional monuments, one at each corner and one at the center of each end line.

The location monument on which this notice is posted is situated within Section 26, Township 8 South, Range 18 East, Gila and Salt River Baseline and Meridian, Arizona, and this claim occupies the following quarter section(s), section(s), Township, and Range:

Quarter Section	Section	Township	Range
<u>1/4</u>	<u>Section</u>	<u>8 South</u>	<u>18 East</u>
<u>1/4</u>	<u>Section</u>	<u>8 South</u>	<u>18 East</u>
<u>SE 1/4</u>	<u>26 Section</u>	<u>8 South</u>	<u>18 East</u>
<u>SW 1/4</u>	<u>25 Section</u>	<u>8 South</u>	<u>18 East</u>

The northeast corner of this claim is 100 feet east and 4100 feet south of the northeast corner of Section 26, Township 8 South, Range 18 East, Gila and Salt River Baseline and Meridian.

DATED AND POSTED on the ground this 16th day of December, 2008, at 11:02 a.m.

Timothy Marsh
 Timothy Marsh

T. 8 S., R. 18 E. G&SRBM

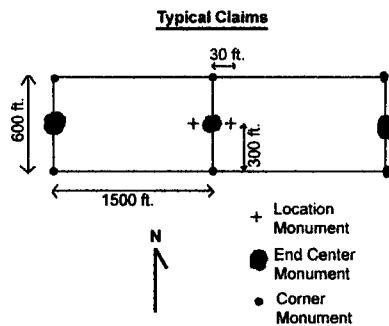
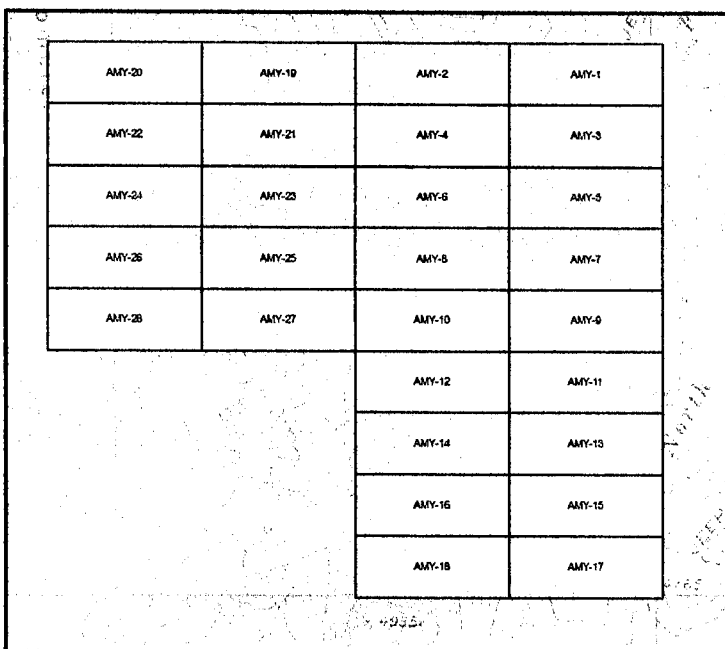

RECEIVED
 B.L.M. AZ STATE OFFICE
 2009 MAR 12 A 11:17
 PHOENIX, AZ

AMC 396291

Scale: 1 inch = 2,000 feet

The above map depicts the AMY-15 lode mining claim, which is located in Section 26, Township 8 South, Range 18 East, Gila and Salt River Baseline and Meridian, Pinal County, Arizona. The claim corners, end centers, and location monuments are marked by 2 inch by 2 inch by 5-foot wooden posts with aluminum tags. The bearings and distances between claim corners are as depicted on the map.

When recorded return to:
 Timothy Marsh
 9420 E. Placita Oaxaca
 Tucson, AZ 85749



**OFFICIAL RECORDS OF
 PINAL COUNTY RECORDER
 LAURA DEAN-LYTL**

DATE/TIME: 12/17/08 1013
 FEE: \$14.00
 PAGES: 1
 FEE NUMBER: 2008-119827

LOCATION NOTICE FOR LODE MINING CLAIM

NOTICE IS HEREBY GIVEN that the AMY-17 lode mining claim has been located by Timothy Marsh, Bell Resources (Nevada) Corporation, whose current mailing address is 9420 E. Placita Oaxaca, Tucson, Arizona, 85749. The general course of this claim is East - West, and it is situated in Pinal County, Arizona. This claim is 1500 feet in length and 600 feet in width. This claim runs from the location monument on which this location notice is posted approximately 1470 feet in an easterly direction to the East end line and 30 feet in a westerly direction to the West end line. This claim is marked by six additional monuments, one at each corner and one at the center of each end line.

The location monument on which this notice is posted is situated within Section 26, Township 8 South, Range 18 East, Gila and Salt River Baseline and Meridian, Arizona, and this claim occupies the following quarter section(s), section(s), Township, and Range:

Quarter Section	Section	Township	Range
<u>NE</u> 1/4	<u>35</u> Section	8 South	18 East
<u>NW</u> 1/4	<u>36</u> Section	8 South	18 East
<u>SE</u> 1/4	<u>26</u> Section	8 South	18 East
<u>SW</u> 1/4	<u>25</u> Section	8 South	18 East

The northeast corner of this claim is 100 feet east and 4700 feet south of the northeast corner of Section 26, Township 8 South, Range 18 East, Gila and Salt River Baseline and Meridian.

DATED AND POSTED on the ground this 16th day of December, 2008, at 10:34 a.m./~~pm~~.

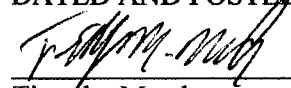
 Timothy Marsh

RECEIVED
 B.L.M. AZ STATE OFFICE
 2009 MAR 12 A 11: 17
 PHOENIX, AZ

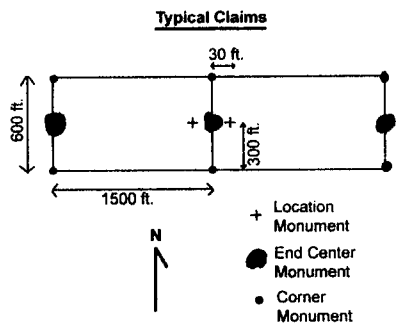
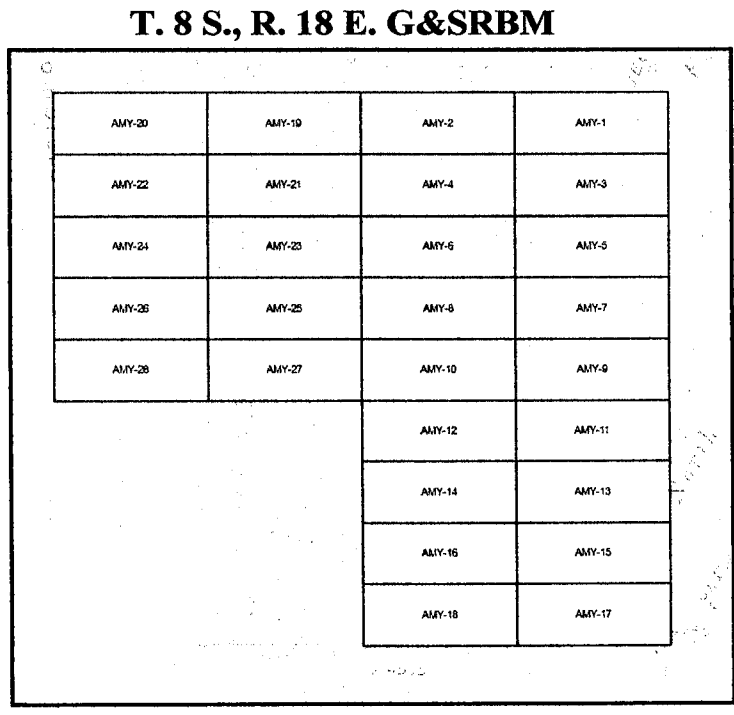

Scale: 1 inch = 2,000 feet
 The above map depicts the AMY-17 lode mining claim, which is located in Section 26, Township 8 South, Range 18 East, Gila and Salt River Baseline and Meridian, Pinal County, Arizona. The claim corners, end centers, and location monuments are marked by 2 inch by 2 inch by 5-foot wooden posts with aluminum tags. The bearings and distances between claim corners are as depicted on the map.

AMB 396292

Input Parameters for Geographic Report with Land

System Id = CR

Admin State = AZ

Geo State =

Casetype Begins With

Case Disp Txt = AUTHORIZED, CANCELLED, EXPIRED, PENDING, REJECTED, RELINQUISHED, VOID, WITHDRAWN

Mer Twp Rng =

Section =

Mtrs = 14 0080S 0180E 026

Commodity =

Commodity Txt =

Pending Org =

Pend Org Decode =

Total Rows Returned: 0

TOWNSHIP 8 SOUTH RANGE 18 EAST OF THE GILA AND SALT RIVER MERIDIAN, ARIZONA

PINAL COUNTY

STATUS OF PUBLIC DOMAIN
LAND AND MINERAL TITLES

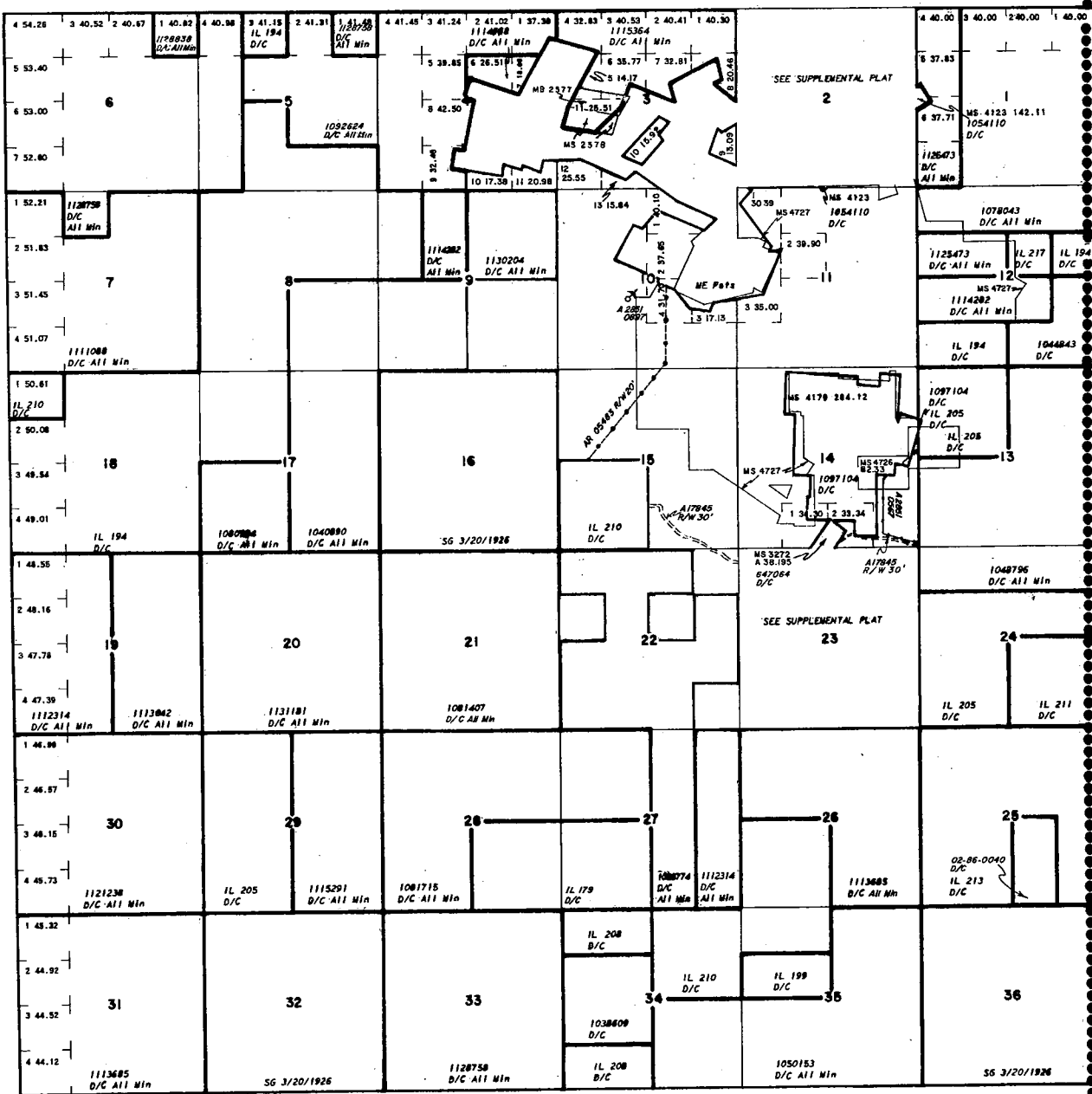

REBORROW TRACT NO	ORIGINAL SURVEY		
	T	R	SECTION

FOR ORDERS EFFECTING DISPOSAL OR USE OF UNIDENTIFIED LANDS WITHDRAWN FOR CLASSIFICATION, MINERALS, WATER AND/OR OTHER PUBLIC PURPOSES, REFER TO INDEX OF MISCELLANEOUS DOCUMENTS.

DIST. NO. 4
MDS 781 NE
782 NW
783 SE

CURRENT TO	BY

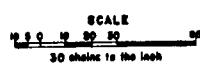

Lat. 32°41'08" N
Long. 110°26'54" W

WARNING STATEMENT
This plat is the Bureau's Record of Title, and should be used only as a graphic display of the township survey data. Records hereon do not reflect title changes which may have been effected by lateral movements of rivers or other bodies of water. Refer to the cadastral surveys for official survey information.

T. 8 S.
R. 18 E.